

Montageanweisung  
Installation Instructions  
Notice d'installation  
Istruzioni per il montaggio

Instrucciones de montaje  
Инструкция по монтажу  
安装说明

## DIL3M80, DIL3AM85 DIL4M115, DIL4AM145 DIUL3M80/11 – DIUL4AM145/11 SDAINL3M125 – SDAINL4AM250

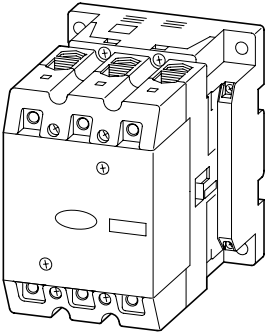

Austausch  
Exchange  
Remplacement  
Sostituzione  
Substitución  
Замена  
替换

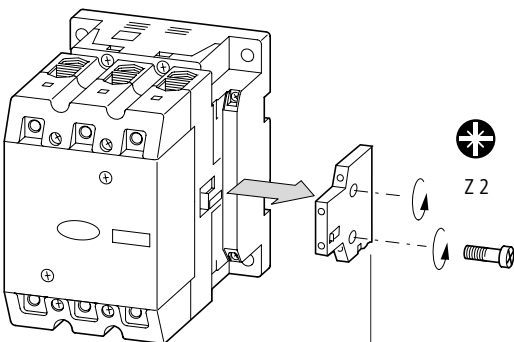

DILM820-XHI-11-SI



**Lebensgefahr durch elektrischen Strom!**  
Nur Elektrofachkräfte und elektrotechnisch unterwiesene Personen dürfen die im folgenden beschriebenen Arbeiten ausführen.

**Electric current! Danger to life!**

Only skilled or instructed persons may carry out the following operations.

**Tension électrique dangereuse !**

Seules les personnes qualifiées et averties doivent exécuter les travaux ci-après.

**Pericolo di morte causa corrente elettrica!**

Solo persone istruite e qualificate possono eseguire le operazioni di seguito riportate.

**¡Corriente eléctrica! ¡Peligro de muerte!**

El trabajo a continuación descrito debe ser realizado por personas cualificadas y advertidas.

**Электрический ток! Опасно для жизни!**

Только специалисты или проинструктированные лица могут выполнять следующие операции.

触电危险!

只允许专业人员和受过专业训练的人员进行下列工作。

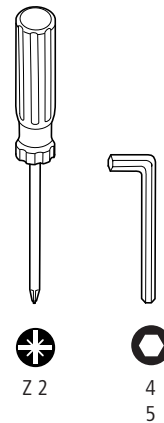

Erweiterung  
Expansion  
Extension  
Ampliamento  
Expansión  
Дополнительная установка  
扩大

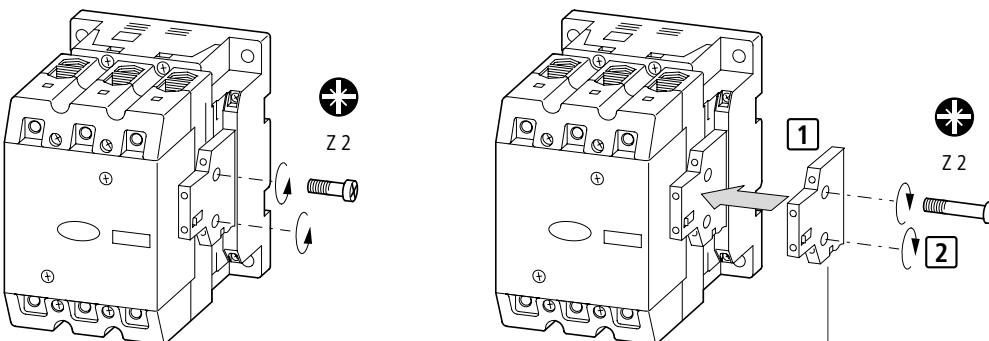

DILM820-XHI-11-SA

Einbaulage  
 Mounting position  
 Position de montage  
 Posizione di montaggio  
 Técnica de conexión  
 Положение установки  
 安装位置

Schraubbefestigung  
 Screw fixing  
 Fixation par vis  
 Fissaggio a vite  
 Fijación por tornillo  
 Крепление под винты  
 固定螺栓

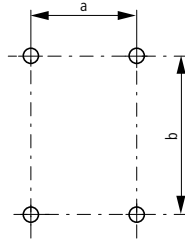
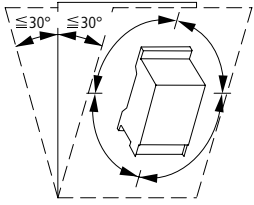

	a	b	
DIL3M80	80	110	2 M5 × 20
DIL3AM85			
DIL4M115	100	130	2 M6 × 20
DIL4AM145			



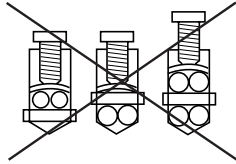

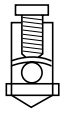
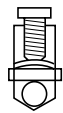
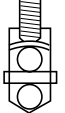

Anschlußtechnik  
 Terminations  
 Technique de raccordement  
 Tipi di collegamento  
 Técnica de conexión  
 Техника присоединения  
 连接技术

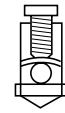
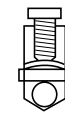

### DIL3(A)M...

	mm <sup>2</sup>	mm <sup>2</sup>	mm <sup>2</sup>	Nm
	6 – 16	6 – 16	6 – 16	6
	4 – 50	4 – 50	4 – 50	6
	4 – 50	4 – 50	4 – 50	6
	16 – 70	16 – 70	16 – 70	6
	6 × 9 × 0.8	6 × 9 × 0.8	6 × 9 × 0.8	6

### DIL4(A)M...

	mm <sup>2</sup>	mm <sup>2</sup>	mm <sup>2</sup>	Nm
	–	–	–	–
	16 – 70	16 – 70	16 – 70	10
	16 – 70	16 – 70	16 – 70	10
	16 – 70	16 – 70	16 – 70	10
	6 × 16 × 0.8	6 × 16 × 0.8	6 × 16 × 0.8	10

### DILM500-XMV

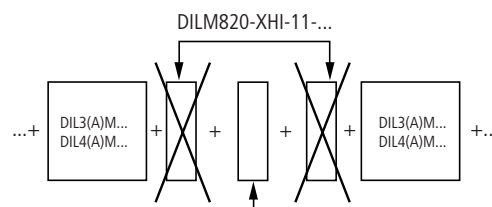
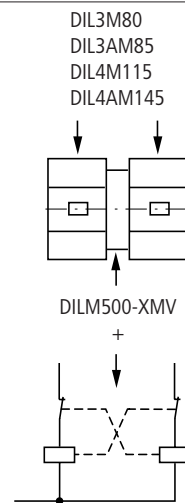
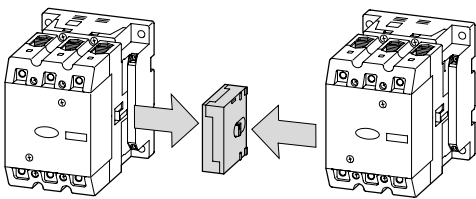

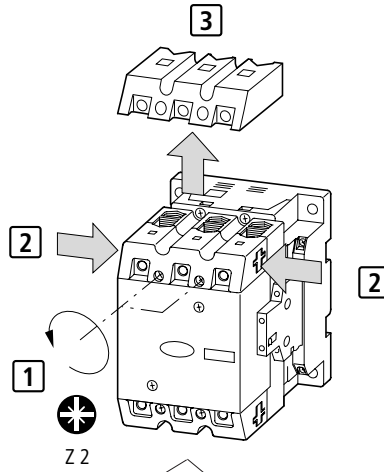
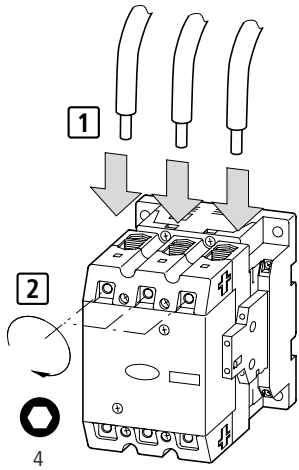

11/99 AWA 2100-1706

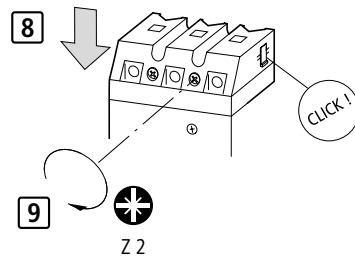
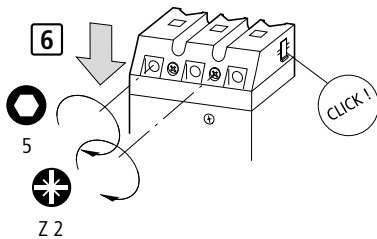
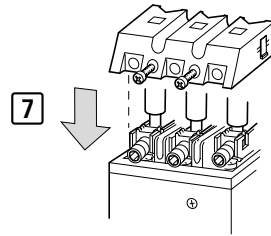
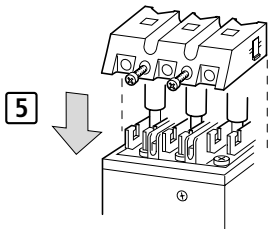
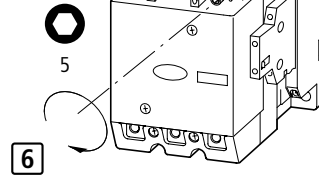
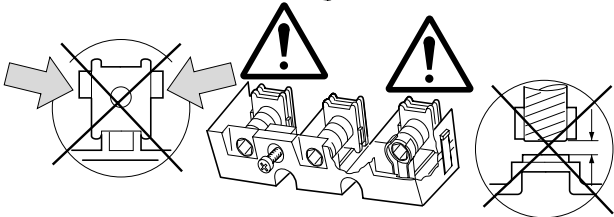
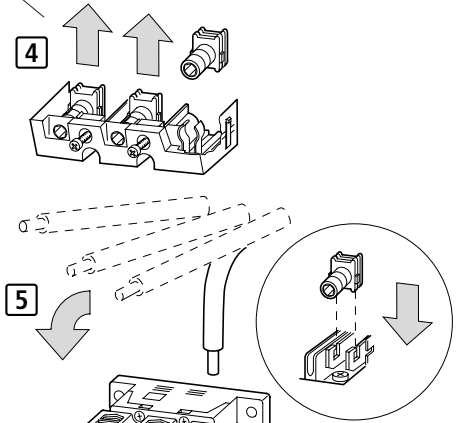
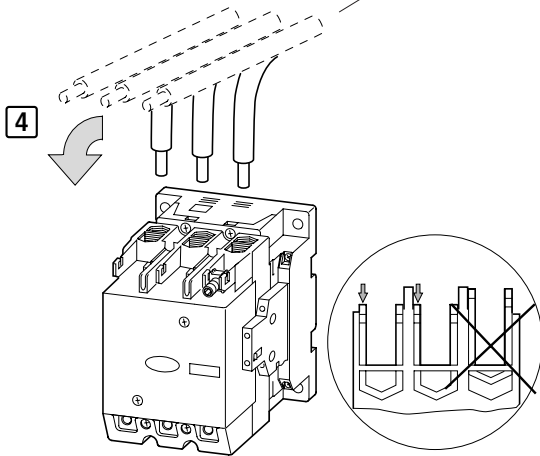

Auswahlrichtlinien siehe Hauptkatalog  
 For selection criteria see Main Catalogue  
 Courbe de sélection: voir Catalogue Général  
 Per i criteri di scelta vedi catalogo specifico  
 Véase Catálogo General para los criterios de selección  
 Рекомендации по подборке см. в Основном каталоге  
 选择原则参见主目录

DIL... + Z...

DIUL3M80/11(+Z5-...) – DIUL4AM145/11(+Z5-...)

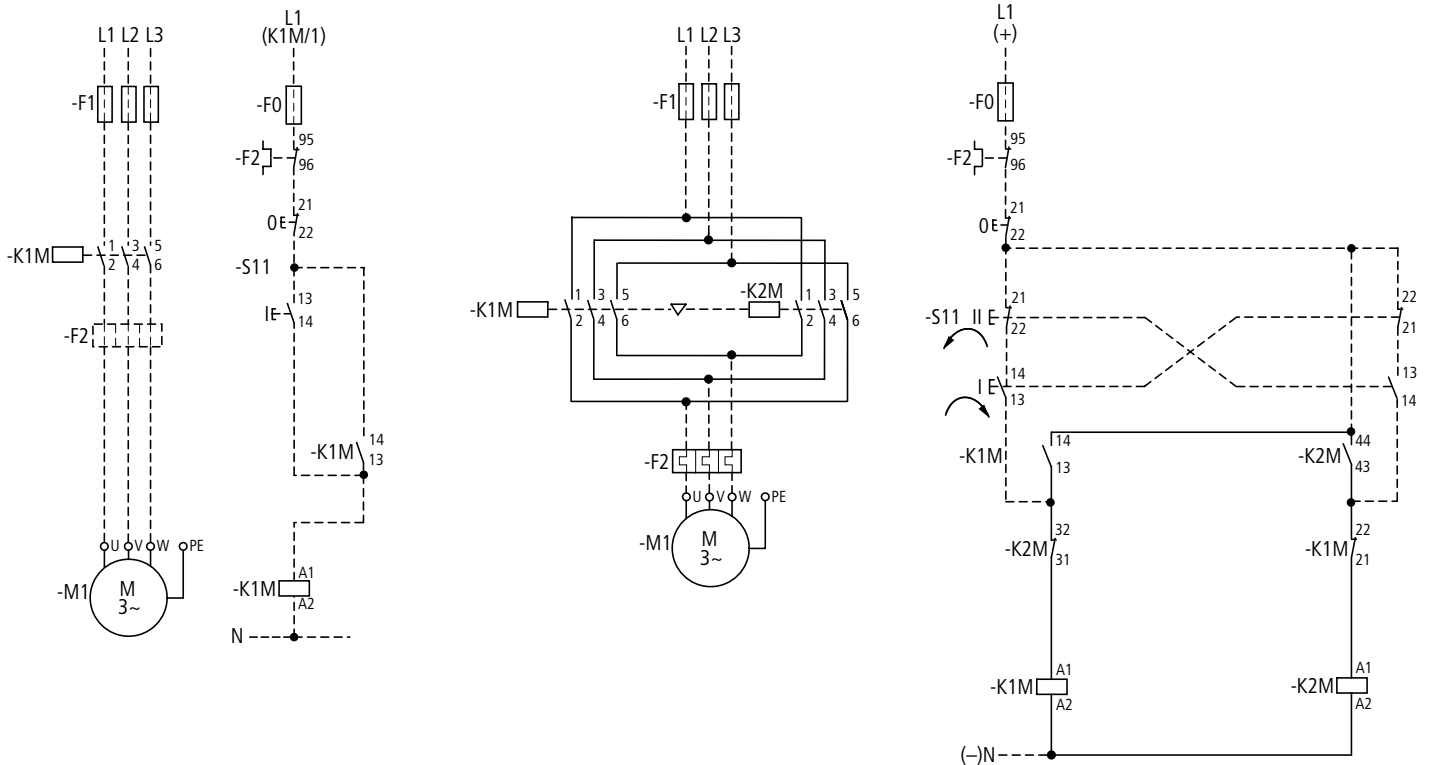

K1M Netzschütz Rechtslauf Linksslauf	Mains contactor clockwise anti-cloawise	Contacteur de ligne marche à droite marche à gauche	Contattore di linea rotazione a destra rotazione a sinistra	Contactor de linea marcha a la derecha marcha a la izquierda	Сетевой контактор Правое вращение Сетевой контактор Левое вращение	电力接触器 正转 电力接触器 反转
--	---	---	---	--	---	----------------------------

SDAINL3M125(+Z5-...) –  
SDAINL4AM250(+Z5-...)

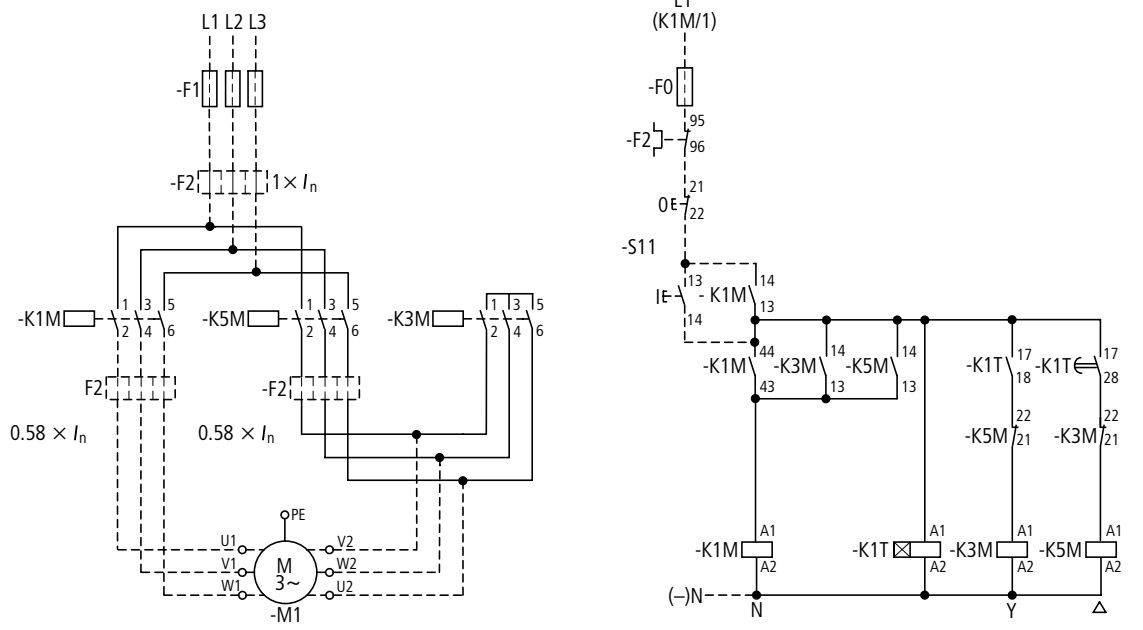

K1M Netzschütz K3M Sternschütz K5M Dreieckschütz K1T Zeitrelais	Mains contactor Star contactor Delta contactor Timing relay	Contacteur de ligne Contacteur étoile Contacteur triangle Relais temporisé	Contattore di linea Contattore a stella Contattatore a triangolo Temporizzatore	Contactor de linea Contactor estrella Contactor triángulo Temporizador	Сетевой контактор Контактор для соединения звездой Контактор для соединения треугольником Реле времени	电力接触器 星形接触器 三角形接触器 定时继电器
--	--	---	--	---	---	-----------------------------------

11/99 AWA 2100-1706