

# CS Wall-Mounted Sheet Steel Enclosures with Mounting Plate



## Product Information

CS Wall-mounted Sheet Steel Enclosures  
with Mounting Plate

Accessories

**X** *board*

**X** *pole*

**X** *comfort*

**X** *patch*

**X** *clever home*

**MOELLER**

We keep power under control.

For Moeller Electric Sales and Support call [KMparts.com](http://KMparts.com) (866) 595-9616

# CS Wall-Mounted Sheet Steel Enclosures

## Technical features at a glance

Available in 45 sizes ...  
from 250x200x150 mm to 1200x1200x250 mm

The stable CS enclosures series made of solid sheet steel is ideal wherever an effective protection against direct contact with live parts is required. The high degree of protection (IP55) not only provides full protection against most adverse environmental conditions, but also protects the systems and equipment inside the enclosures against their harmful consequences.

Tightness is guaranteed through a continuously foamed polyurethane sealing. An all-around rainwater drain profile prevents liquids (such as water or oil) and dirt from penetrating when opening the door.

Shock resistance rating is IK10 according to EN 62262, hence the inside equipment of the enclosures is also protected against mechanical impacts. CS enclosures can be installed as wall-mounted enclosures. A rough-type paint applied in the powder-coating method provides for non-abrasive corrosion protection.

The door of the enclosure is easy to remove in case any further mechanical work needs to be carried out. Concealed inside hinges are easy to remove for this purpose and provide for quick and easy reversal of the hinging from left to right and vice-versa.

- **Rainwater drain profile**  
Prevents liquids (such as water or oil) and dirt from penetrating when opening the door.



- **RAL7035**  
Surface and corrosion protection through a rough-type powder-coating inside and out, RAL 7035.

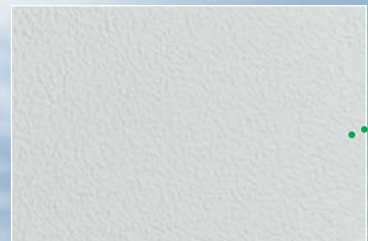

- **Mounting plate**  
Galvanized sheet steel 2.5 - 3 mm thick for safe installation of switchgear and basic EMC protection.



- **Flange plate**  
Sheet steel for own production. The enclosure can be turned by 180° for cable insertion at the top or bottom.



For Moeller Electric Sales and Support call [KMparts.com](http://KMparts.com) (866) 595-9616

- **Stable design of the enclosures**

Made of high-grade sheet steel.  
Protection against mechanical impact: IK10



- **Wall-mounting brackets**

For fixing the enclosures on the wall without the need to intervene from inside.

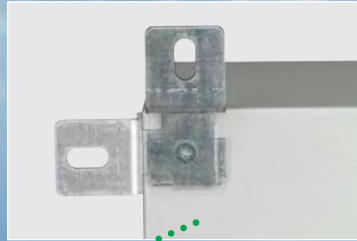

- **Foamed sealing**

Guarantees absolute tightness. IP55 is guaranteed for the entire series.



- **Standardized locking system**

with twist lock.  
For use with standardized locks.



- **Door-hinging**

Optionally left or right-hinged on either 2 or 3 inside hinges.



- **Hinge bolt with quick-change technology**

For quick and easy removal of the door in case of further work to be carried out.

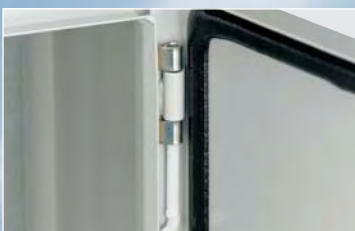



For Moeller Electric Sales and Support call [KMparts.com](http://KMparts.com) (866) 595-9616

# Ordering data

Customized solutions upon request:

- Different RAL colours
- Cut-outs and holes according to customer specifications
- Sizes other than those between CS-2520/150 and CS-1212/250

## CS Wall-Mounted Sheet Steel Enclosures with Mounting Plate

Illustration	Dimensions [mm]			Number of doors	Number of locks	Number of hinges
	Height A	Width B	Depth C			
	250	200	150	1	1	2
	300	200	150	1	1	2
	300	300	150	1	1	2
	300	300	200	1	1	2
	300	400	200	1	1	2
	400	300	150	1	1	2
	400	300	200	1	1	2
	400	400	150	1	1	2
	400	400	200	1	1	2
	400	600	200	1	1	2
	400	600	250	1	1	2
	400	600	300	1	1	2
	500	400	150	1	1	2
	500	400	200	1	1	2
	500	400	250	1	1	2
	500	500	250	1	1	2
	600	400	150	1	2	2
	600	400	200	1	2	2
	600	400	250	1	2	2
	600	500	150	1	2	2
	600	500	200	1	2	2
	600	500	250	1	2	2
	600	600	200	1	2	2
	600	600	250	1	2	2
	600	600	300	1	2	2
	600	800	300	1	2	2
	700	500	200	1	2	2
	700	500	250	1	2	2
	800	400	200	1	2	2
	800	400	250	1	2	2
	800	600	200	1	2	2
	800	600	250	1	2	2
	800	600	300	1	2	2
	800	800	200	1	2	2
	800	800	300	1	2	2
	800	1000	300	1	2	2
	1000	600	250	1	2	3
	1000	600	300	1	2	3
	1000	800	250	1	2	3
	1000	800	300	1	2	3
	1000	1000	300	1	2	3
	1200	600	250	1	2	3
	1200	800	300	1	2	3
	1200	1000	300	1	2	3
1200	1200	250	1	2	3	

For Moeller Electric Sales and Support call [KMparts.com](http://KMparts.com) (866) 595-9616

Flange plate openings with type of		Number	D [mm]	Dimensions [mm] of mounting plate	Weight [kg] incl. mounting plate	Code	Article No.	Units per Package
Blind plate	1	97	200 x 150	3.5	CS-2520/150	111646	1	
Blind plate	1	97	250 x 150	4.0	CS-32/150	111647	1	
Blind plate	1	97	250 x 250	5.5	CS-33/150	111648	1	
Blind plate	1	172	250 x 250	6.1	CS-33/200	111649	1	
Blind plate	1	172	250 x 350	7.7	CS-34/200	111680	1	
Blind plate	1	97	350 x 250	7.0	CS-43/150	111681	1	
Blind plate	1	172	350 x 250	7.7	CS-43/200	111682	1	
Blind plate	1	97	350 x 350	9.2	CS-44/150	111683	1	
Blind plate	1	172	350 x 350	9.9	CS-44/200	111684	1	
Blind plate	1	172	350 x 550	14.6	CS-46/200	111685	1	
Blind plate	1	172	350 x 550	16.7	CS-46/250	111686	1	
Blind plate	1	172	350 x 550	17.7	CS-46/300	111687	1	
Blind plate	1	97	450 x 350	11.1	CS-54/150	111688	1	
Blind plate	1	172	450 x 350	12.0	CS-54/200	111689	1	
Blind plate	1	172	450 x 350	12.9	CS-54/250	111690	1	
Blind plate	1	172	450 x 450	17.0	CS-55/250	111691	1	
Blind plate	1	97	550 x 350	13.6	CS-64/150	111692	1	
Blind plate	1	172	550 x 350	14.6	CS-64/200	111693	1	
Blind plate	1	172	550 x 350	15.6	CS-64/250	111694	1	
Blind plate	1	97	550 x 450	17.8	CS-65/150	111695	1	
Blind plate	1	172	550 x 450	19.0	CS-65/200	111696	1	
Blind plate	1	172	550 x 450	20.4	CS-65/250	111697	1	
Blind plate	1	172	550 x 550	22.4	CS-66/200	111698	1	
Blind plate	1	172	550 x 550	23.6	CS-66/250	111699	1	
Blind plate	1	172	550 x 550	25.2	CS-66/300	111700	1	
Blind plate	1	172	550 x 750	31.9	CS-68/300	111701	1	
Blind plate	1	172	650 x 450	21.7	CS-75/200	111702	1	
Blind plate	1	172	650 x 450	23.3	CS-75/250	111703	1	
Blind plate	1	172	750 x 350	20.8	CS-84/200	111704	1	
Blind plate	1	172	750 x 350	22.2	CS-84/250	111705	1	
Blind plate	1	172	750 x 550	30.1	CS-86/200	111706	1	
Blind plate	1	172	750 x 550	31.7	CS-86/250	111707	1	
Blind plate	1	172	750 x 550	33.5	CS-86/300	111708	1	
Blind plate	1	172	750 x 750	38.0	CS-88/200	111709	1	
Blind plate	1	172	750 x 750	40.7	CS-88/300	111710	1	
Blind plate	1	172	750 x 950	42.5	CS-810/300	111711	1	
Blind plate	1	172	950 x 550	39.1	CS-106/250	111712	1	
Blind plate	1	172	950 x 550	40.9	CS-106/300	111713	1	
Blind plate	1	172	950 x 750	49.8	CS-108/250	111714	1	
Blind plate	1	172	950 x 750	51.9	CS-108/300	111715	1	
Blind plate	1	172	950 x 950	63.0	CS-1010/300	111716	1	
Blind plate	1	172	1150 x 550	46.2	CS-126/250	111717	1	
Blind plate	1	172	1150 x 750	60.9	CS-128/300	111718	1	
Blind plate	1	172	1150 x 950	74.3	CS-1210/300	111719	1	
Blind plate	1	172	1150 x 1150	78.0	CS-1212/250	111720	1	

For Moeller Electric Sales and Support call [KMparts.com](http://KMparts.com) (866) 595-9616

# Accessories

## Set of Wall-Mounting Brackets

- For fixing the enclosures on the wall
- Vertical or horizontal mounting
- Material of the angles: Galvanized sheet steel, 3 mm thick
- One set includes 4 wall-mounting angles plus mounting accessories

VT07507

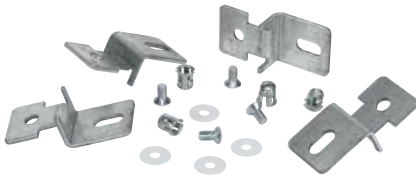

Description	Type Designation	Article No.	Units per Package
up to 800 x 600	WFB-SET-CS	112639	1
from 800 x 800	WFB-SET/HW-CS	116055	1

## Canopy

- For direct fixing on the base body of the enclosures
- Material: Sheet steel, powder-coated, RAL7035
- Fastening material included in the delivery

VT19407



For enclosure sizes [mm]			Type Designation	Article No.	Units per Package
Width	Depth	Height of Top			
200	150	54	CNP-2/150-CS	112890	1
300	150	54	CNP-3/150-CS	112891	1
300	200	54	CNP-3/200-CS	112892	1
400	150	54	CNP-4/150-CS	112893	1
400	200	54	CNP-4/200-CS	112894	1
400	250	54	CNP-4/250-CS	112895	1
500	150	54	CNP-5/150-CS	112896	1
500	200	54	CNP-5/200-CS	112897	1
500	250	54	CNP-5/250-CS	112898	1
600	200	54	CNP-6/200-CS	112899	1
600	250	54	CNP-6/250-CS	112900	1
600	300	54	CNP-6/300-CS	112901	1
800	200	54	CNP-8/200-CS	112902	1
800	250	54	CNP-8/250-CS	112903	1
800	300	54	CNP-8/300-CS	112904	1
1000	300	54	CNP-10/300-CS	112905	1
1200	250	54	CNP-12/250-CS	112906	1

## Ventilation Louvers

- For direct fixing on the base body of the enclosures
- Material: Sheet steel, powder-coated, RAL7035
- Fastening material included in the delivery

VT19307



Positioning of the slots	Dimensions [mm]		Type Designation	Article No.	Units per Package
	Height	Width			
vertical	197	117	LVP-20V12-CS	112907	1
horizontal	197	117	LVP-20H12-CS	112908	1
vertical	297	149	LVP-30V15-CS	112909	1
horizontal	297	149	LVP-30H15-CS	112910	1

LC\_CS\_Schloss



### Locks with Inserts

Method of Actuating	Material	Symbol	Type Designation	Article No.	Units per Package
3mm Two-way key bit	Metal	☉	LCM3-CS	112911	1
5mm Two-way key bit	Polyamide	☉	LCP5-CS	112912	1
5mm Two-way key bit	Metal	☉	LCM5-CS	112913	1
Cylinder	Polyamide	ⓘ	LCPZ-CS	116396	1
Cylinder	Metal	ⓘ	LCMZ-CS	116395	1

### Bottom Panels with F3A Flange Openings <sup>1)</sup>

- With foamed sealing, IP55 degree of protection max. if F3A is correctly applied
- Material: Sheet steel, powder-coated, RAL7035
- Can also be used as a top panel after turning the enclosure by 180°

VT18907, VT19007, VT19107, VT19207

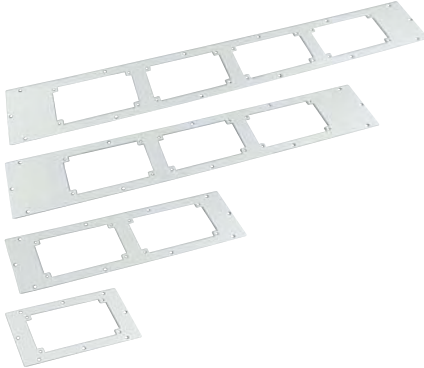

For enclosure sizes [mm] Width	No. of F3A flanges	Type Designation	Article No.	Units per Package
300	1	AFP-3-CS	112914	1
400	1	AFP-4-CS	112915	1
500	1	AFP-5-CS	112916	1
600	2	AFP-6-CS	112917	1
800	3	AFP-8-CS	112918	1
1000	3	AFP-10-CS	112919	1
1200	4	AFP-12-CS	112920	1

<sup>1)</sup> Do not apply for CS-.../150



### F3A Flanges insulating material

VT17407, VT17507, VT17307, VT17607, VT17707, VT17807, VT17207, VT09208



	Type Designation	Article No.	Units per package
Blind flange	F3A-0	74182	1
4xM16, 6xM25/16, 8xM32/20	F3A-4	81301	1
2xM20, 8xM25/16, 4xM32/20, 1xM50/32	F3A-8	91468	1
2xM16, 12xM20, 2xM40/25, 2xM50/32	F3A-12	76555	1
24xM16, 13xM20	F3A-34	78928	1
2 Grommets for cables up to Ø 70mm	F3A-KTD	83674	1
Cellular rubber insertion flange 40 cables Ø 10-13mm 4 cables Ø 17-21mm 2 cables Ø 27-30mm	F3A-D	10145	1

# Accessories

	Cable Insertion	Hole Diameter mm	Outer Cable Diameter mm	Use of Cable NYM/NYY, 4-wire mm <sup>2</sup>	Type Designation	Article No.	Units per Package
<b>Membrane Grommets - Metric</b>							
<ul style="list-style-type: none"> <li>• IP66, with integrated insertion membrane</li> <li>• PE and thermoplastic elastomer, halogen-free</li> </ul>							
 VT06508	M16	16.5	1 – 9	H03VV-F3 x 0.75 mm <sup>2</sup> , NYM 1 x 16/3 x 1.5 mm <sup>2</sup>	KT-M16	216983	100
	M20	20.5	1 – 13	H03VV-F3 x 0.75 mm <sup>2</sup> , NYM 5 x 1.5/5 x 2.5 mm <sup>2</sup>	KT-M20	207602	100
	M25	25.5	1 – 18	H03VV-F3 x 0.75 mm <sup>2</sup> , NYM 4 x 10 mm <sup>2</sup>	KT-M25	207603	100
	M32	32.5	1 – 25	H03VV-F3 x 0.75 mm <sup>2</sup> , NYM 4 x 16/5 x 10 mm <sup>2</sup>	KT-M32	207604	100
<b>Cable Glands - Metric, According to EN 50262</b>							
<b>Cable glands, metric, with counternut and integrated strain relief</b>							
<ul style="list-style-type: none"> <li>• IP68 up to 5 bar, polyamide, halogen-free</li> <li>• Fire classification V2 according to UL94</li> </ul>							
 VT05708	M12	12.5	3 – 7	H03VV-F 3 x 0.75 mm <sup>2</sup> , NYM 1 x 2.5 mm <sup>2</sup>	V-M12	215078	20
	M16	16.5	4.5 – 10	H03VV-F 3 x 1.5 mm <sup>2</sup> , NYM 1 x 16/3 x 1.5 mm <sup>2</sup>	V-M16	215077	20
	M20	20.5	6 – 13	H05VV-F 4 x 2.5/3 x 4 mm <sup>2</sup> , NYM 5 x 1.5/5 x 2.5 mm <sup>2</sup>	V-M20	206910	20
	M25	25.5	9 – 17	H05VV-F 5 x 2.5/5 x 4 mm <sup>2</sup> , NYM 5 x 2.5/5 x 6 mm <sup>2</sup>	V-M25	206911	20
	M32	32.5	13 – 21	NYM 5 x 10 mm <sup>2</sup>	V-M32	206912	10
	M40	40.5	16 – 28	NYM 5 x 16 mm <sup>2</sup>	V-M40	209668	10
	M50	50.5	21 – 35	NYM 4 x 35/5 x 25 mm <sup>2</sup>	V-M50	206913	5
M63	63.5	34 – 48	NYM 4 x 35 mm <sup>2</sup>	V-M63	214835	3	
<b>Multiple sealing, metric, for cable glands V-M...</b>							
 VT06708	M25	–	4 x 5 – 6	H03VV-F 2 x 0.75/3 x 0.75 mm <sup>2</sup>	MFD25	215451	25
	M32	–	4 x 3.5 – 7	H03VV-F 4 x 0.75 mm <sup>2</sup>	MFD32	215452	25
<b>Sealing plugs for spare openings in multiple sealing MFD...</b>							
 VT07208	M25	–	–	–	MFV25-6	215453	50
	M32	–	–	–	MFV32-7	215454	50
<b>Grommets</b>							
<ul style="list-style-type: none"> <li>• For a panel thickness of 2 to 3 mm</li> <li>• PVC</li> </ul>							
 VT05608	–	58	14 – 54	–	KT3	031523	2
	–	75	14 – 68	–	KT4	036269	3



Cable Insertion	Hole Diameter mm	Outer Cable Diameter mm	Use of Cable NYM/NYY, 4-wire mm <sup>2</sup>	Type Designation	Article No.	Units per Package
-----------------	---------------------	----------------------------	--	------------------	-------------	-------------------

### Grommets/Cable Glands for Pressure Compensation

#### Ventilation grommet with filter disc, metric

- For use at the bottom or side of the enclosures, PE and PVC

VT06608



M25	25.5	–	–	KT-M25F	224556	50
-----	------	---	---	---------	--------	----

#### Cable gland for ventilation IP56

- For use at the bottom or side of the enclosures, polyamide, halogen-free
- Permeable to air, non-permeable to dust
- To prevent condensation of water

VT05808



M20	20.5	–	–	STB-M20F	224557	20
M25	25.5	–	–	STB-M25F	224558	20

### Earthing set for door, BFZ-DES

- Cross section 6 mm<sup>2</sup>
- Inclusive assembly accessories

VT19305

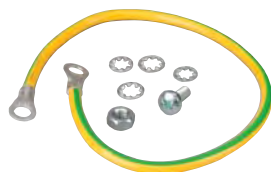

Description	Type Designation	Article-No.	Units per package
	BFZ-DES	101665	1

### Circuit Diagram Bag SPT

- Made of insulating material, fixing by self-sticker

wa\_vt04907



Description	Type Designation	Article No.	Units per package
DIN A4 crosswise	SPT4	002275	1
DIN A5 crosswise	SPT5	002276	1
DIN A6 crosswise	SPT6	002277	1

### Flask with Brush Applicator, BPZ-CPS-7035

VT09405



Colour	Type Designation	Article No.	Units per package
RAL 7035	BPZ-CPS-7035	286771	1

# Technical Specifications

## CS Wall-Mounted Sheet Steel Enclosures with Mounting Plate



Degree of protection	IP55 IK10
Standards	IEC/EN 60529 IEC 62262, IEC/EN 62208 NFC 15-100
Marking	CE
Scope of delivery	<ul style="list-style-type: none"><li>- Mounting plate incl. fastening material</li><li>- Flange blind plate with mounting accessories</li><li>- Sealing plugs to be used for closing wall-mounting holes</li><li>- Fastening material for earth conductor connection</li><li>- 1 key</li></ul>

### Design

#### *Base body of the enclosure*

Stable design of the enclosures thanks to sheet steel of 1.2 mm thickness and 1.5 mm as of enclosure width 500. Bent and seam-welded. The rear panel features holes of 10 mm diameter for wall-mounting.

#### *Door*

Sheet steel of 1.2 mm thickness or 1.5 mm as of enclosure size 400x400. Door is right-hinged and offers an opening angle of 120°. Thanks to easy-to-remove hinges it can optionally be left or right-hinged. The hinges are concealed inside the enclosure. Tightness is guaranteed through a continuously foamed polyurethane sealing. Door profile with perforations every 50 mm standard for all enclosure sizes.

#### *Mounting plate*

2.5 mm galvanized sheet steel, 3.00 mm as of enclosure size 800x600. Distance to the rear wall 15 mm. The mounting plate can be mounted from inside, on M8 threaded copper welding pins at the rear of the enclosures. The mounting plate is thus automatically connected with the corpus electrically. A protective grounding connection is additionally not necessary.

#### *Lock*

Polyamide twist lock with protective insulation. Standard locking with a 3 mm two-way key bit. One lock up to a height of 500 mm, two locks as of a height of 600 mm.

#### *Flange plate opening*

Positioned in the rear area of the enclosures for easy wiring on the mounting plate.

#### *Surface*

Base body and door in light-grey, RAL7035, rough-type polyester powder-coating.

#### *RoHS*

The CS enclosure series complies with the requirements of the 2002/95/EC Directive of the European Parliament and of the Council.

For Moeller Electric Sales and Support call [KMparts.com](http://KMparts.com) (866) 595-9616

**General Information**

Resistance to climatic influences	Constant, moist heat in compliance with IEC 60068-2-78, cyclical in compliance with IEC 60068-2-30
Ambient temperature	-40°C / +70°C
Weight of equipment - door	20 kg
Total weight of equipment	300 kg with vertically fixed mounting angles

**Amount of heat to be dissipated**

Amount of heat to be dissipated (power loss)  $P_L$  [W] for all-over closed, wall-mounted Moeller CS sheet steel enclosures without internal separations  
 Example: Max. ambient temperature 35°C; excess temperature  $\Delta T = 20$  K; relative humidity = 75%

Code	Max. power loss $P_L$		Max. power loss $P_L$
	Single wall-mounted enclosure	First wall-mounted enclosure	Wall-mounted enclosure in the center
CS-2520/150	11 W	10 W	9 W
CS-32/150	13 W	11 W	10 W
CS-33/150	16 W	15 W	14 W
CS-33/200	19 W	18 W	16 W
CS-34/200	23 W	22 W	21 W
CS-43/150	21 W	19 W	18 W
CS-43/200	24 W	22 W	20 W
CS-44/150	25 W	24 W	22 W
CS-44/200	29 W	27 W	25 W
CS-54/150	30 W	28 W	27 W
CS-54/200	35 W	32 W	30 W
CS-46/200	39 W	37 W	35 W
CS-46/250	44 W	42 W	39 W
CS-46/300	49 W	46 W	43 W
CS-54/250	39 W	36 W	33 W
CS-55/250	45 W	42 W	39 W
CS-64/150	35 W	33 W	31 W
CS-64/200	40 W	37 W	34 W
CS-65/150	42 W	39 W	37 W
CS-65/200	47 W	44 W	41 W
CS-64/250	45 W	42 W	38 W
CS-65/250	55 W	49 W	45 W
CS-66/200	54 W	51 W	48 W
CS-66/250	60 W	56 W	52 W
CS-66/300	65 W	61 W	57 W
CS-68/300	81 W	76 W	72 W
CS-75/200	53 W	50 W	47 W
CS-75/250	59 W	55 W	51 W
CS-84/200	51 W	47 W	44 W
CS-84/250	57 W	53 W	48 W
CS-86/200	68 W	64 W	60 W
CS-86/300	82 W	76 W	70 W
CS-88/200	85 W	81 W	77 W
CS-86/250	75 W	70 W	65 W
CS-88/300	101 W	95 W	89 W
CS-810/300	120 W	113 W	108 W
CS-106/250	91 W	85 W	79 W
CS-106/300	99 W	91 W	84 W
CS-108/250	112 W	106 W	100 W
CS-108/300	121 W	113 W	106 W
CS-1010/300	143 W	136 W	128 W
CS-126/250	106 W	99 W	92 W
CS-128/300	141 W	132 W	123 W
CS-1210/300	166 W	158 W	149 W
CS-1212/250	180 W	173 W	166 W

# Dimensions

## With door

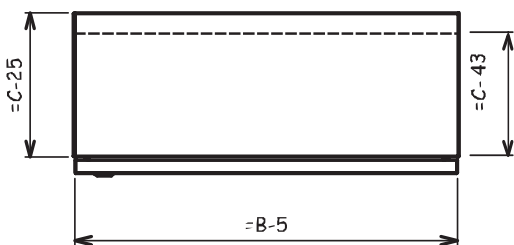
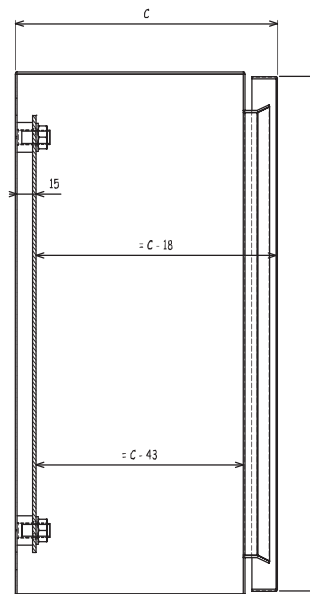
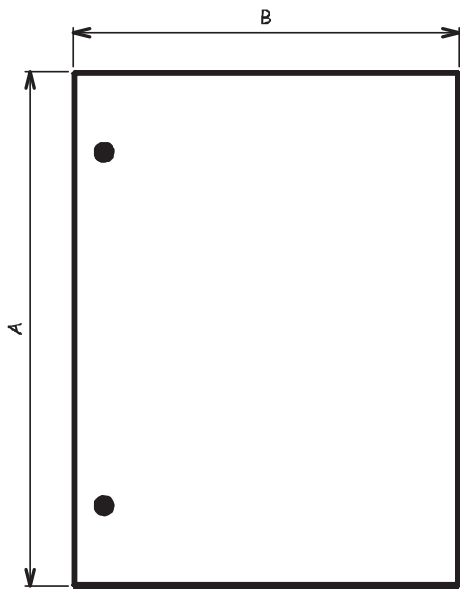
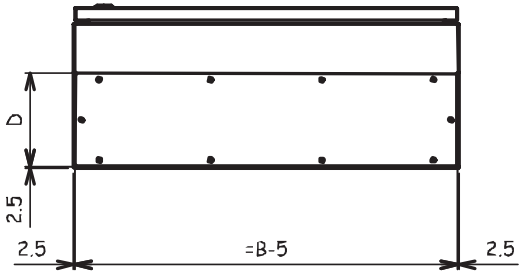

## Without door

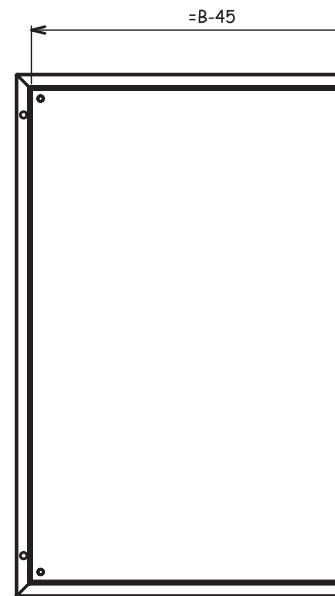
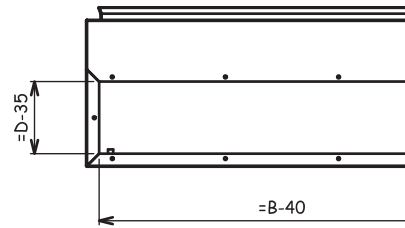

## Wall-mounting bracket

### WFB-SET-CS

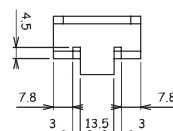
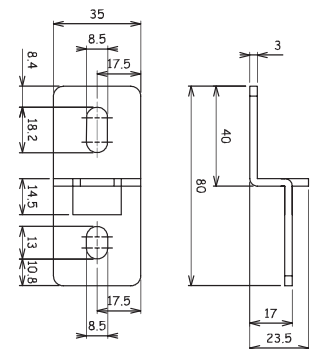

Note:  
Please refer to selection pages 4/5  
for A, B, C, D values

For Moeller Electric Sales and Support call [KMparts.com](http://KMparts.com) (866) 595-9616

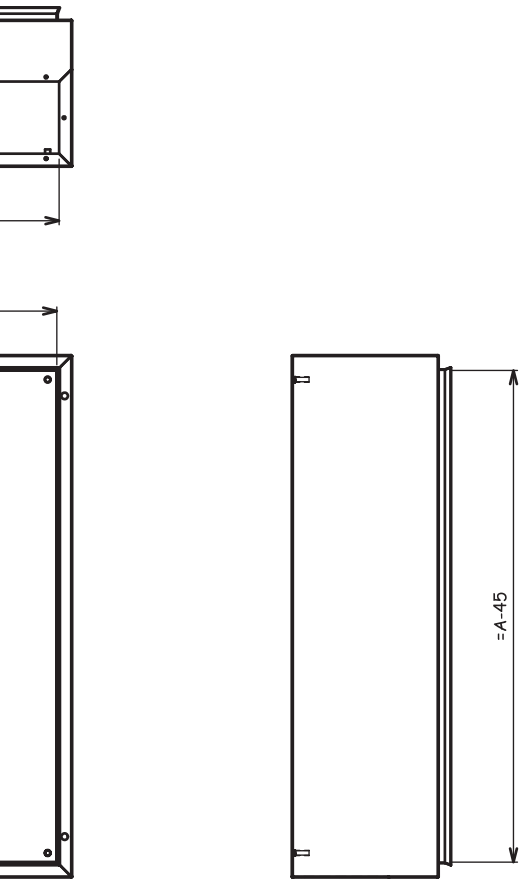

### Door profile

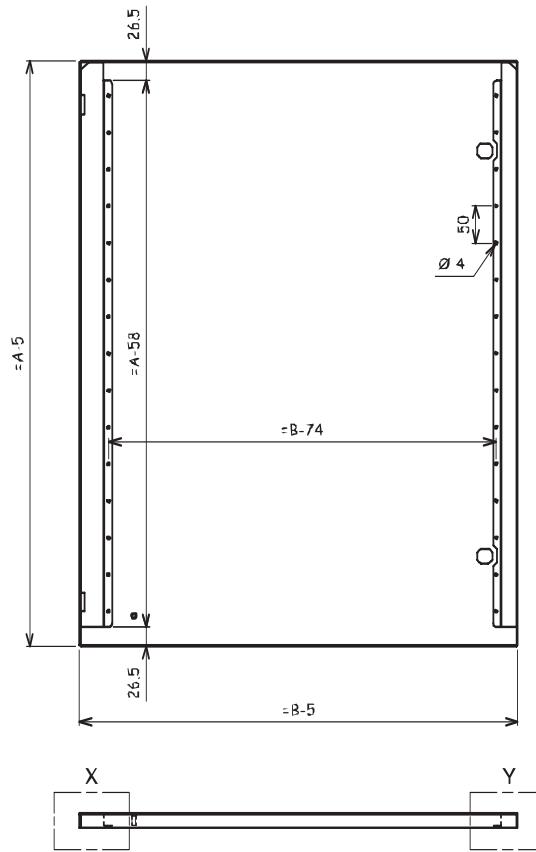

### Mounting opening - Lock

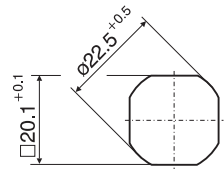

Detail X

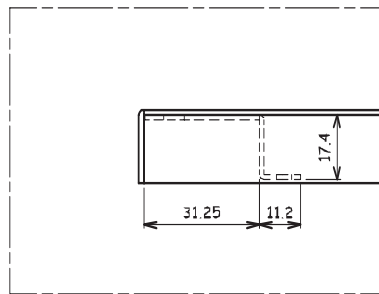

Detail Y

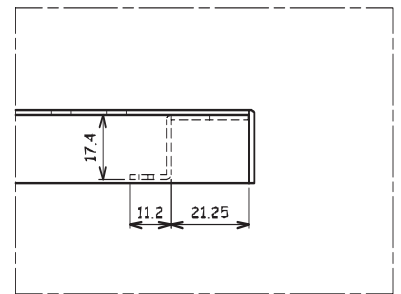

### WFB-SET/HW-CS

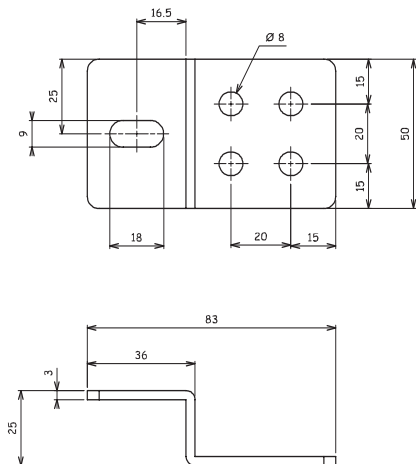

### Wall mounting holes

up to CS-86/...

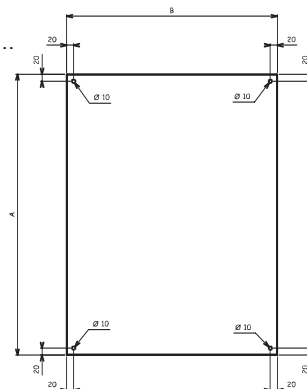

from CS-88/...

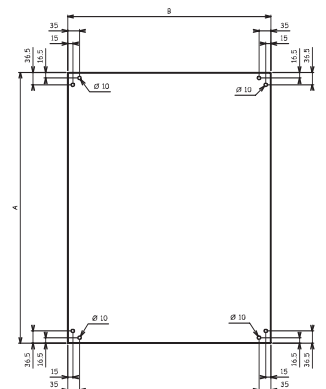

For Moeller Electric Sales and Support call [KMparts.com](http://KMparts.com) (866) 595-9616

# Dimensions

## Mounting plate

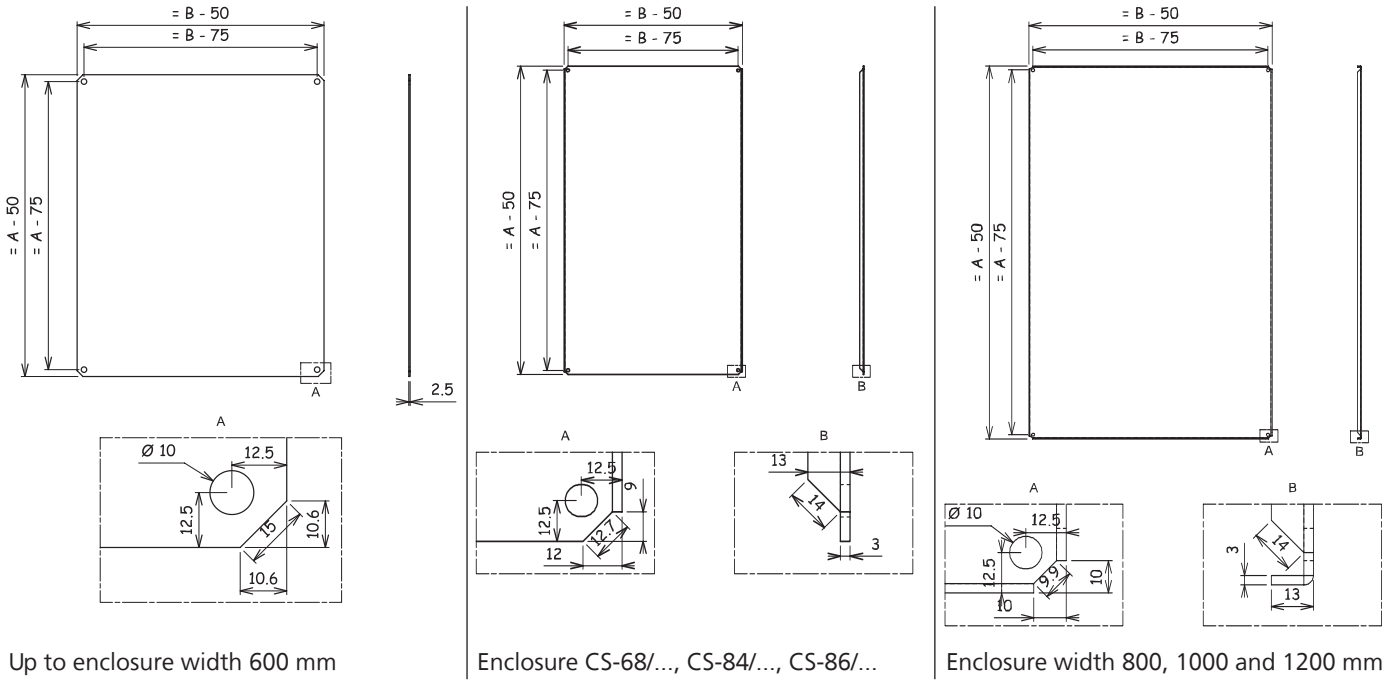

## Locker position

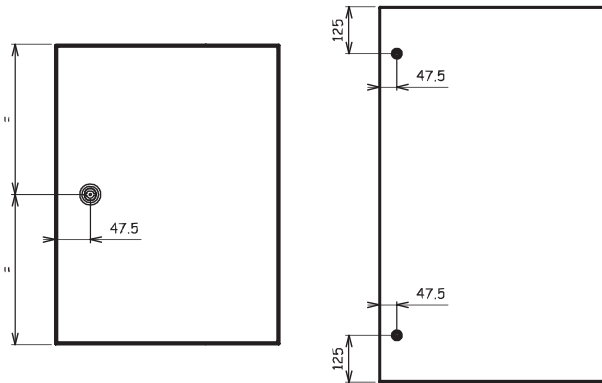

## Rear wall - position of screw pins

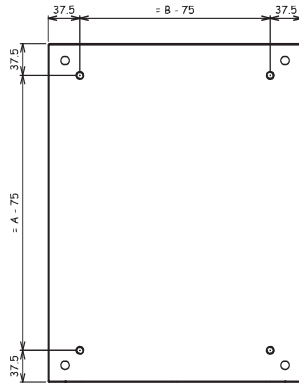

## Ventilation louvers

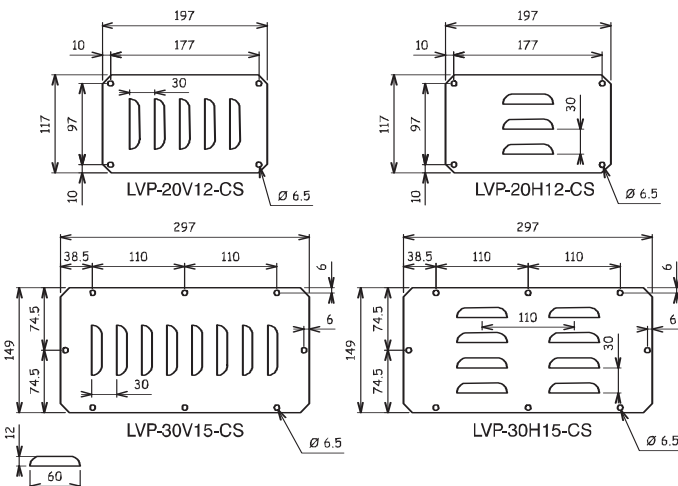

## Canopy

For Moeller Electric Sales and Support call [KMparts.com](http://KMparts.com) (866) 595-9616

**Bottom of enclosure (with F3A flange openings)**

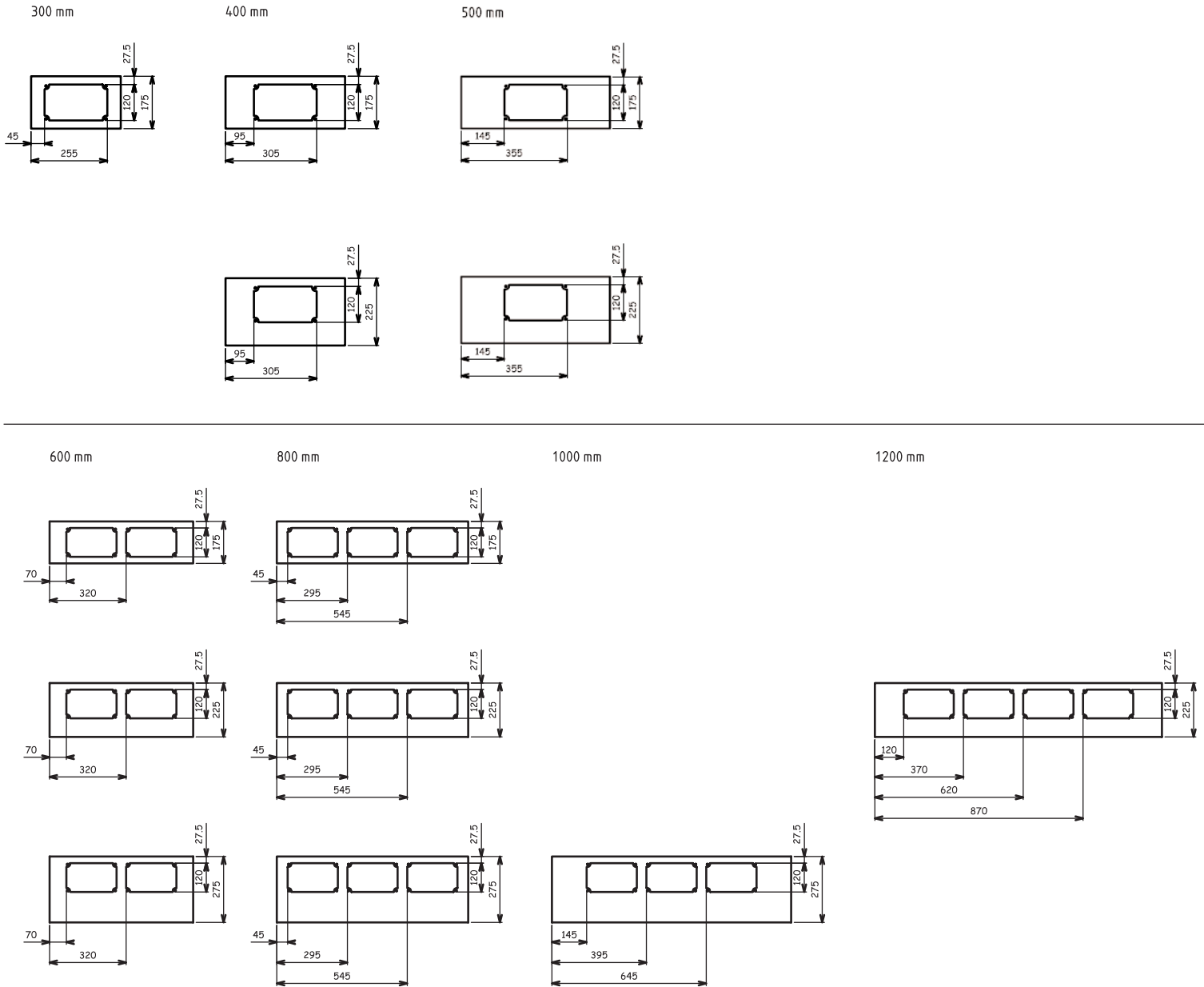

**Moeller Gebäudeautomation KG  
Eugenia 1  
A-3943 Schrems**

**E-mail: [sales.lowvoltage.systems@moeller.net](mailto:sales.lowvoltage.systems@moeller.net)  
Internet: [www.moeller.at](http://www.moeller.at)**

© 2008 by Moeller Gebäudeautomation  
Subject to alterations  
Printed in Austria (07/07)  
Layout: Werbeweber, Schrems  
Article No.  
FK4300-1178E

**MOELLER** 

We keep power under control.

For Moeller Electric Sales and Support call [KMparts.com](http://KMparts.com) (866) 595-9616