

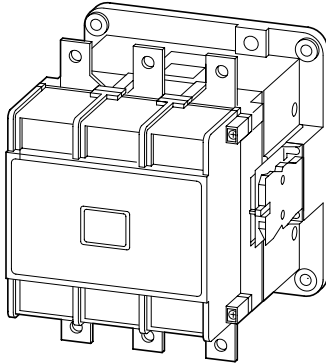

04/99 AWA 2100-827

## DIL 11-22, DIL 11-11/G DIL 13-22, DIL 13-11/G + HV DIL 11, HV DIL 13

04/99 AWA 21-827



### Lebensgefahr durch elektrischen Strom!

Nur Elektrofachkräfte und elektrotechnisch unterwiesene Personen dürfen die im folgenden beschriebenen Arbeiten ausführen.

### Electric current! Danger to life!

Only skilled or instructed persons may carry out the following operations.

### Tension électrique dangereuse !

Seuls les personnes qualifiées et averties doivent exécuter les travaux ci-après.

### Pericolo di morte causa corrente elettrica!

Solo persone istruite e avvertite possono eseguire le operazioni di seguito riportate.

### ¡Corriente eléctrica! ¡Peligro de muerte!

El trabajo a continuación descrito debe ser realizado por personas cualificadas y advertidas.

### Электрический ток! Опасно для жизни!

Только специалисты или проинструктированные лица могут выполнять следующие операции.

### 触电危险!

只允许专业人员和受过专业训练的人员进行下列工作。

**1**

Einbaulage:  
 Mounting position:  
 Position de montage  
 Posizione di montaggio  
 Posición de montaje:  
 Положение при монтаже:  
 安装位置:

Montage  
 Mounting  
 Montage  
 Montaggio  
 Montaje:  
 Монтаж  
 安装

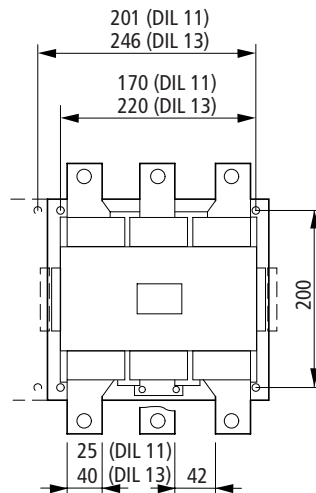
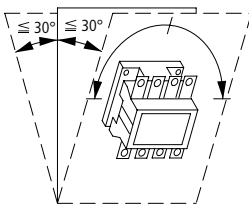

4 M6 x 30

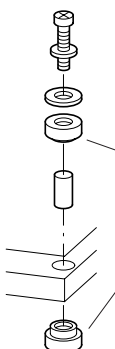

Dämpfungs- Elemente  
 Fitting damping elements  
 Elements amortisseurs  
 Elemento ammortizzatore  
 Elementos amortizadores  
 Амортизирующие детали  
 阻尼元件

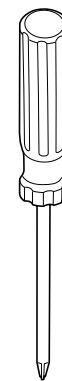

Z 2

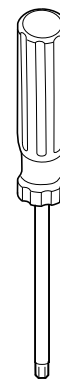

T 15  
 T 20

# 2

Anschlußtechnik  
 Terminations  
 Technique de raccordement  
 Tipi di collegamento  
 Técnica de conexión  
 Соединение  
 接线技术规格

Typ	• mm <sup>2</sup>	•• mm <sup>2</sup>	Nm
K-A-DIL 11	70 – 120 – 300		25 45
K-A-DIL 13	95 – 120 – 300		35 45
K-B-DIL 11		35 – 185	20
K-B-DIL 13		95 – 120 – 300	35 45

DIL 11-11/G

DIL 13-11/G

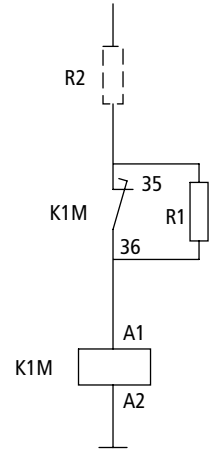
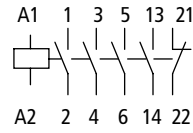

# 3

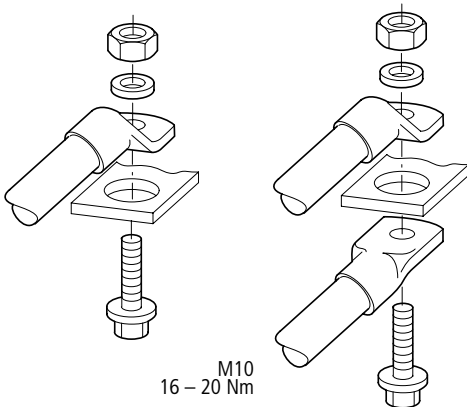

K-A-DIL 13

K-B-DIL 11  
K-B-DIL 13

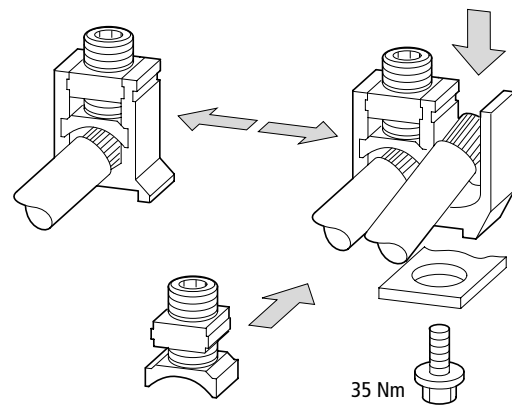

04/99 AWA 2100-827

K-A-DIL 11

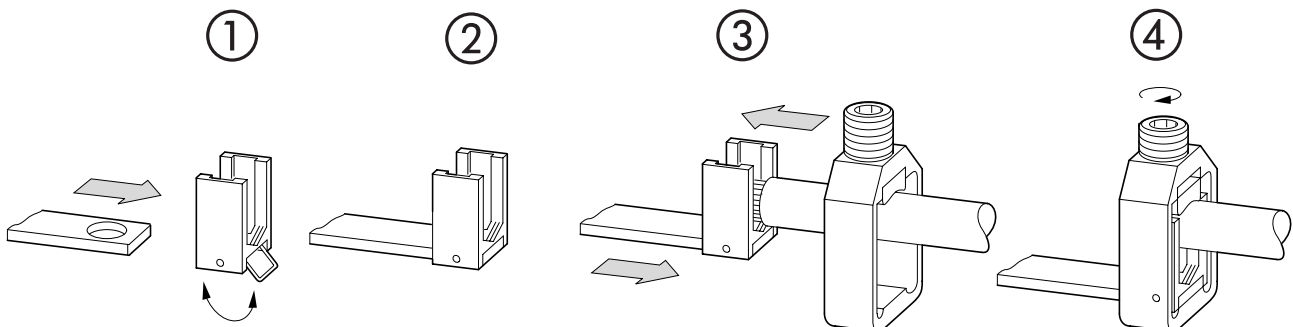

Spulenwechsel  
 Coil changing  
 Remplacement de bobine  
 Sostituzione della bobina  
 Cambio de bobina  
 Замена катушки  
 线圈更换

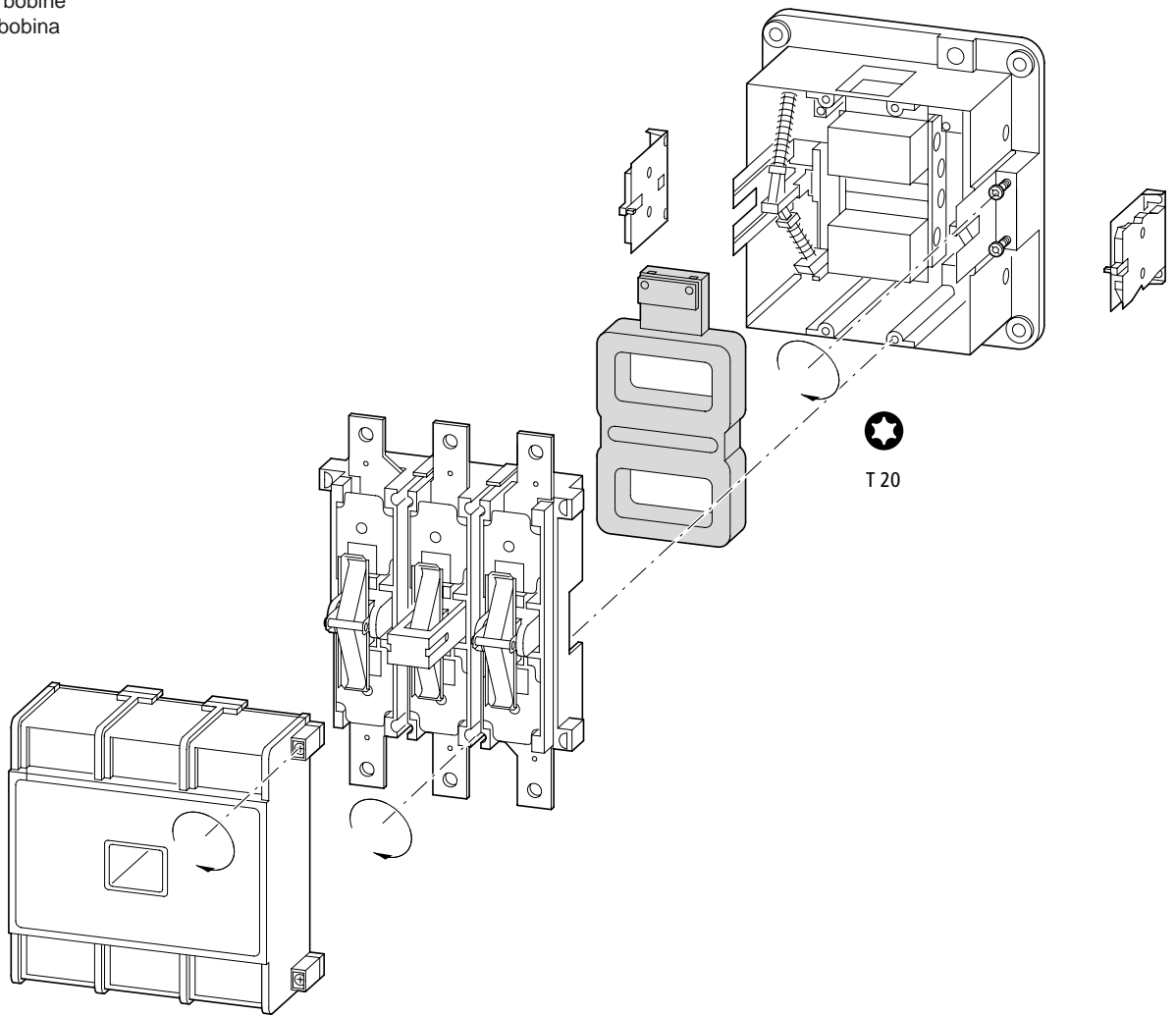

04/99 AWA 2100-827



Nach Montage Funktion prüfen ! After mounting need of function test ! Après montage test de fonction !  
 Controllare il funzionamento dopo il montaggio ! Verificar funcionamiento después del montaje !  
 После монтажа проверить функционирование! 装配后检查功能!

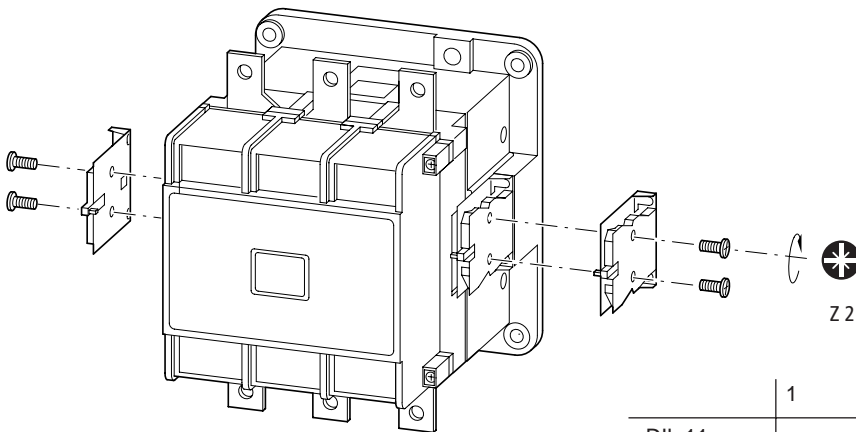

1 + 2 + DIL + 3 + 4

	1	2	3	4
DIL 11 DIL 13		DIL P 800- XHI-SI	DIL P 800- XHI-SI	
		DIL P 800- XHI-SI	DIL P 800- XHIV-SRI	
	DIL P 800- XHI-SA	DIL P 800- XHI-SI	DIL P 800- XHI-SI	DIL P 800- XHI-SA
	DIL P 800- XHI-SA	DIL P 800- XHI-SI	DIL P 800- XHIV-SRI	
DIL 11...-G DIL 13...-G		DIL P 800- XHI-SI	DIL P 800- XHI-SA	
	DIL P 800- XHI-SA	DIL P 800- XHI-SI	DIL P 800- XHI-SI	

Schaltstückwechsel  
 Contact changing  
 Remplacement des  
 elements de contact  
 Sostituzione dei  
 contatti di potenza  
 Cambio de los elementos  
 de contacto  
 Замена контактов  
 接触件更换

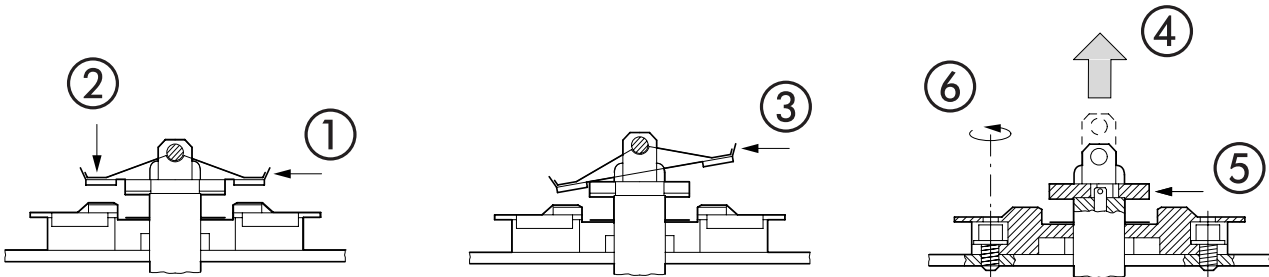
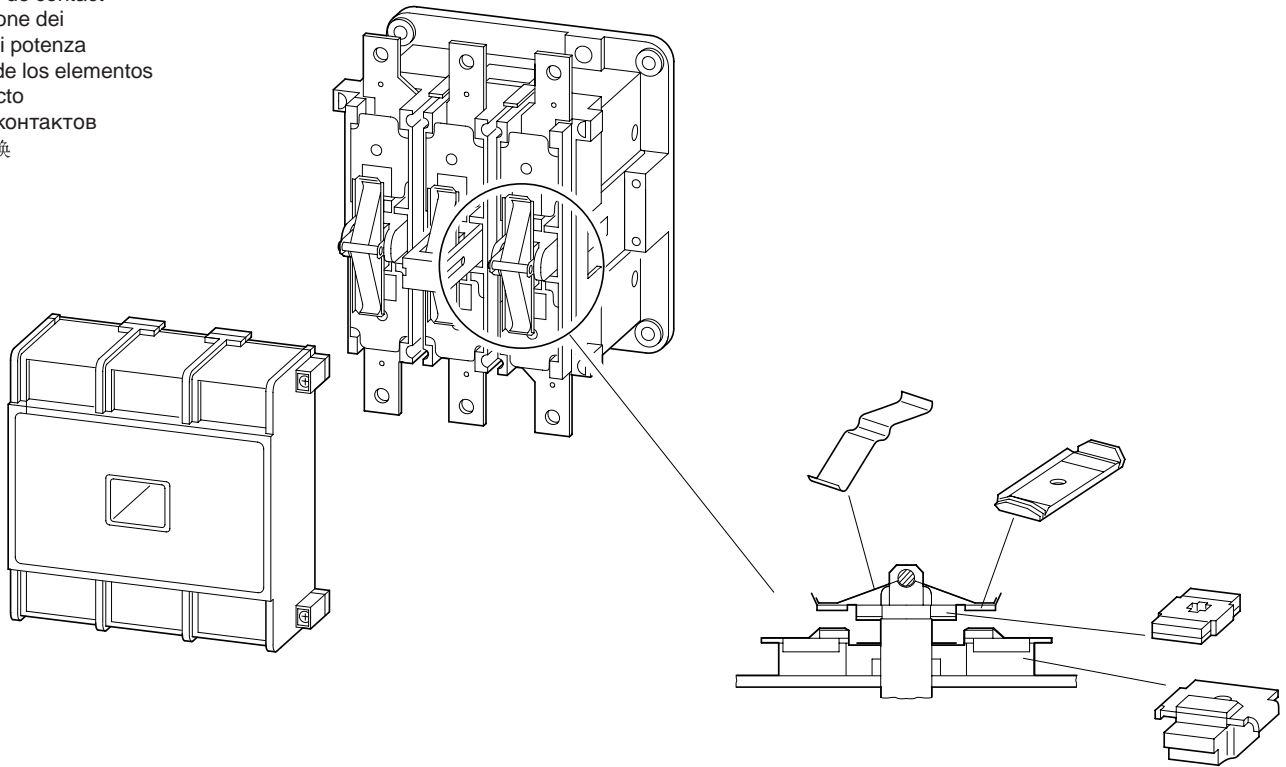

Bausatz komplett in umgekehrter Reihenfolge montieren  
 Fit assembly kit completely, in reverse order  
 Monter le jeu complet de pièces dans l'ordre inverse  
 Montare i pezzi nell'ordine inverso  
 Montar el juego completo de piezas en orden inverso  
 Сборка блока производится в обратном порядке  
 整套组件以相反的顺序进行装!

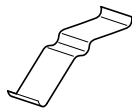

3 Federn  
 3 springs  
 3 ressorts  
 3 Molle  
 3 resortes  
 3 пружины  
 弹簧



3 Kontakte  
 3 contacts  
 3 contacts  
 3 contatti  
 3 contactos  
 3 контакты  
 接触件

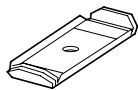

3 Kontakte  
 3 contacts  
 3 contacts  
 3 contatti  
 3 contactos  
 3 контакты  
 接触件

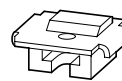

6 Kontakte  
 6 contacts  
 6 contacts  
 6 contatti  
 6 contactos  
 6 контакты  
 接触件



Nach Montage Funktion prüfen ! After mounting need of function test ! Après montage test de fonction !  
 Controllare il funzionamento dopo il montaggio ! Verificar funcionamiento después del montaje !  
 После монтажа проверить функционирование! 装配后检查功能!

04/99 AWA 2100-827

# V- DIL 11, DIL P 800-XMV

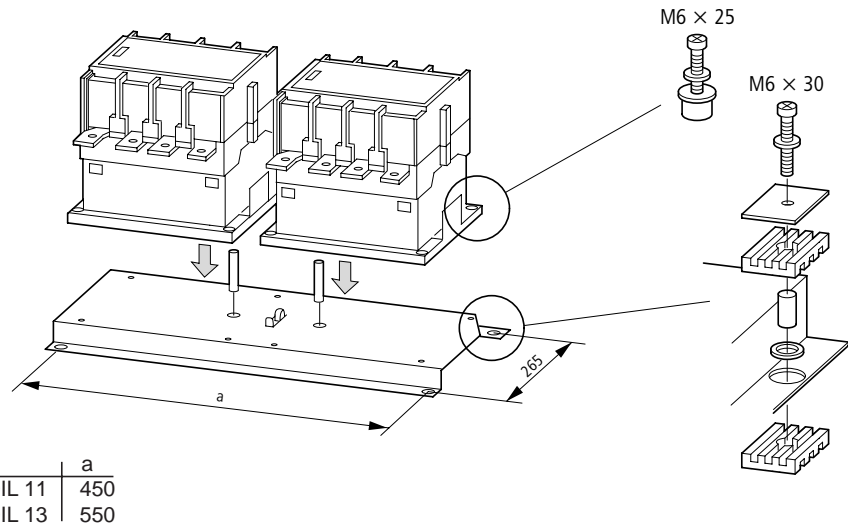

Einbaulage:  
 Mounting position:  
 Position de montage  
 Posizione di montaggio  
 Posición de montaje:  
 Положение при монтаже:  
 安装位置:

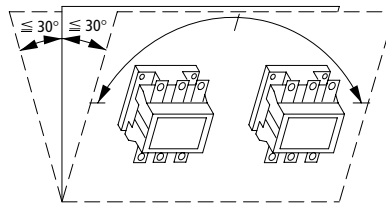

04/99 AWA 2100-827



Nach Montage Funktion prüfen ! After mounting need of function test ! Après montage test de fonction !  
 Controllare il funzionamento dopo il montaggio ! Verificar funcionamiento después del montaje !  
 После монтажа проверить функционирование! 装配后检查功能!

1

# HV DIL 11, HV DIL 13

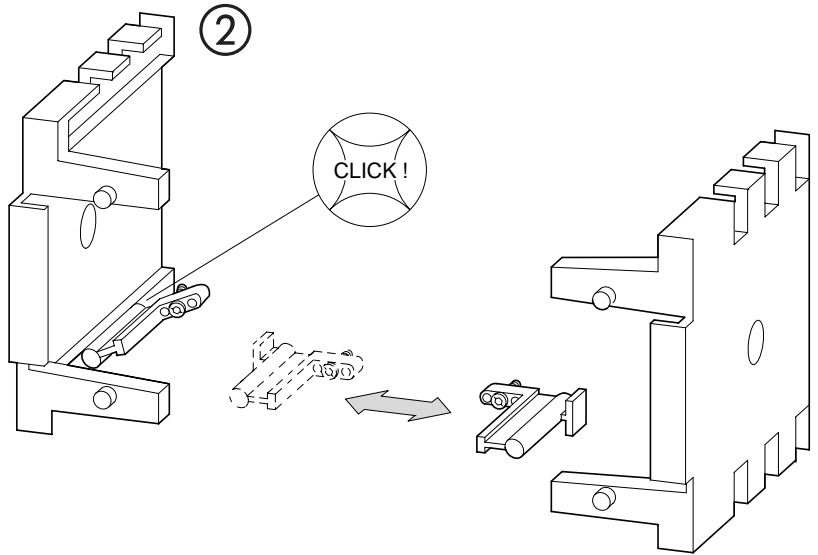
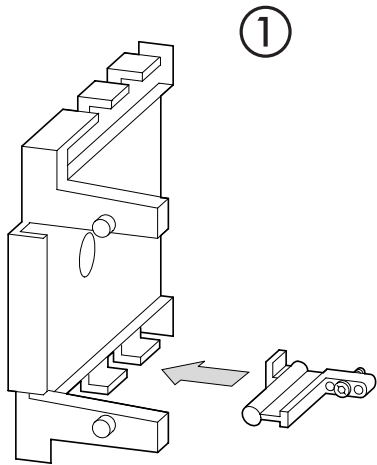

2

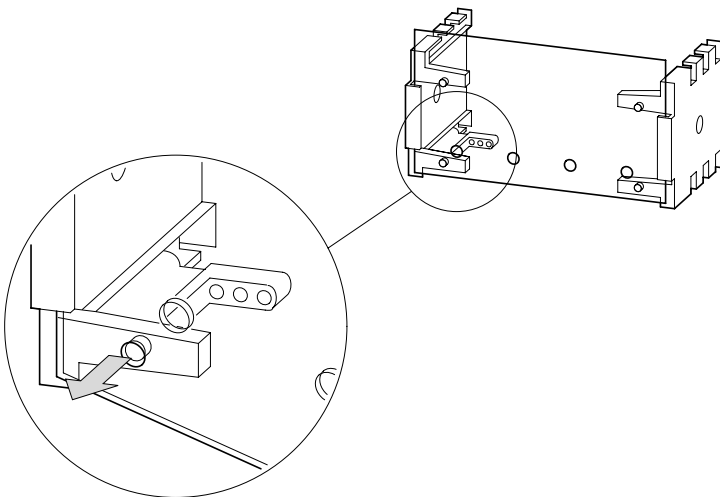

3

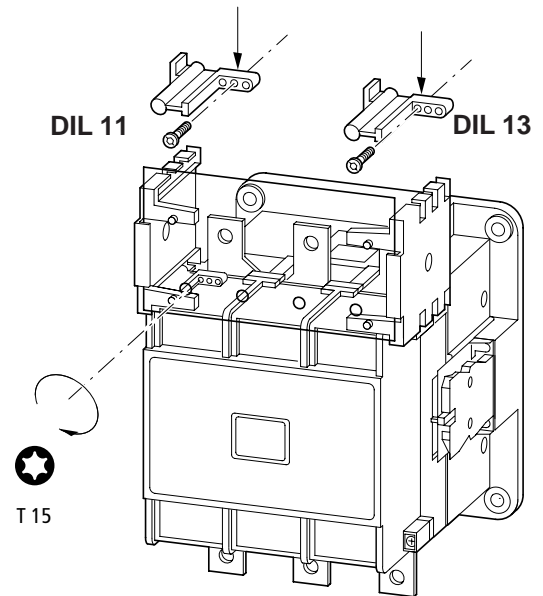

04/99 AWA 2100-827

4

