

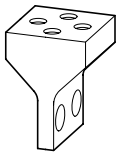

PZ4-AR/...



1600 A

	1 ...2	2 ...4		
	mm ²	mm ²	mm ²	mm ²
	1 × 120 – 185	2 × 95 – 185	(2 ×) 10 × 50 × 1.0	
	2 × 95 – 185	4 × 35 – 185		(2 ×) 50 × 10



Lebensgefahr durch elektrischen Strom!
 Nur Elektrofachkräfte und elektrotechnisch unterwiesene Personen dürfen die im Folgenden beschriebenen Arbeiten ausführen.

Electric current! Danger to life!
 Only skilled or instructed persons may carry out the following operations.

Tension électrique dangereuse !
 Seules les personnes qualifiées et averties doivent exécuter les travaux ci-après.

Tensione elettrica: Pericolo di morte!
 Solo persone abilitate e qualificate possono eseguire le operazioni di seguito riportate.

¡Corriente eléctrica! ¡Peligro de muerte!
 El trabajo a continuación descrito debe ser realizado por personas cualificadas y advertidas.

Электрический ток! Опасно для жизни!
 Только специалисты или проинструктированные лица могут выполнять следующие операции.

触电危险!
 只允许专业人员和受过专业训练的人员进行下列工作。

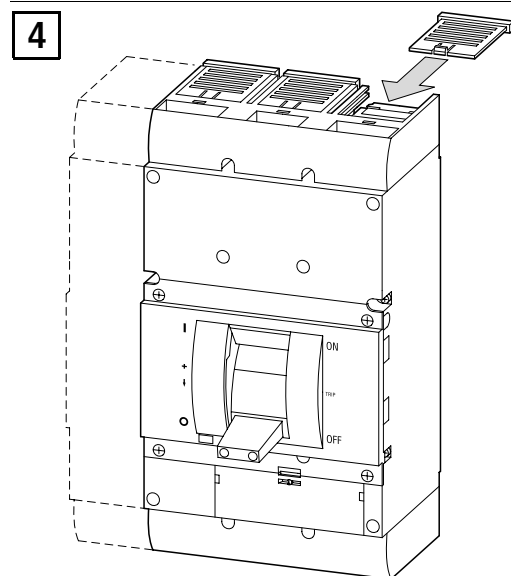
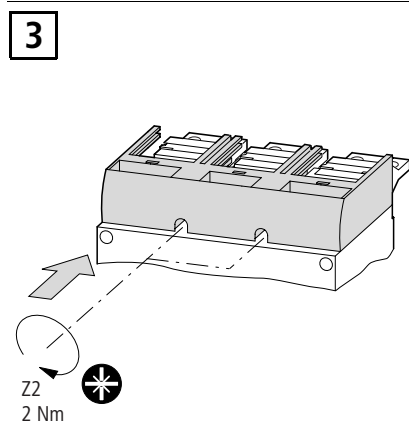
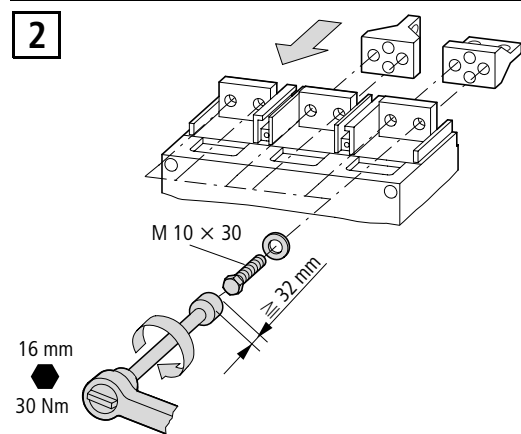
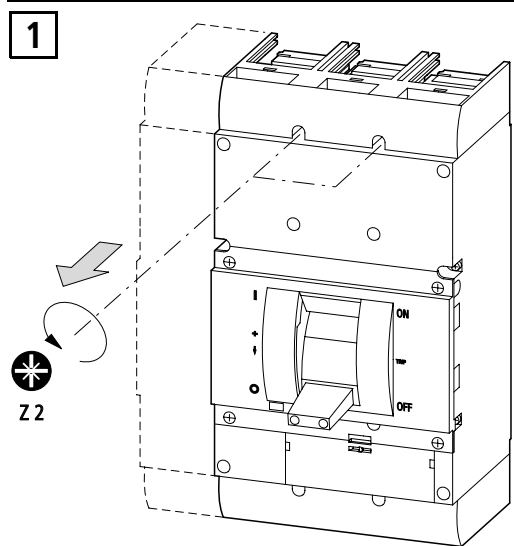

 $I_{cc} \cong 50 \text{ kA}$

Leiter mit einem nichtleitenden Material verbinden, das Kurzschlusskräfte von $I_{cc} \cong 50 \text{ kA}$ aufnehmen kann.

Connect the cable with non-conductive material which can take short-circuit forces of $I_{cc} \cong 50 \text{ kA}$.

Raccorder les conducteurs avec un matériau non conducteur pouvant supporter des courts-circuits de $I_{cc} \cong 50 \text{ kA}$.

Ancorare i cavi con materiale non conduttivo che possa sopportare sollecitazioni di $I_{cc} \cong 50 \text{ kA}$.

Conectar el cable con material no conductor, el cual puede resistir fuerzas de cortocircuito de $I_{cc} \cong 50 \text{ kA}$.

Провод соединить с непроводящим материалом, могущим воспринимать усилия при коротком замыкании $I_{cc} \cong 50 \text{ kA}$.

将导线与能够承受 $I_{cc} \geq 50 \text{ kA}$

断路能力的非导电的材料连接。

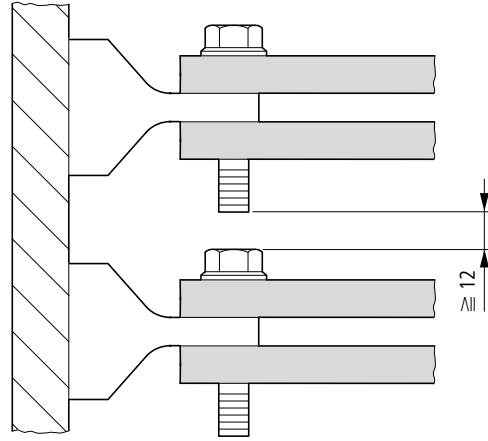
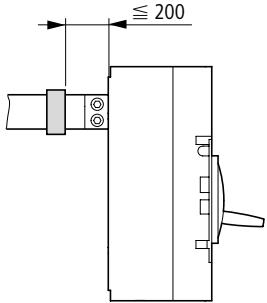

3-pol

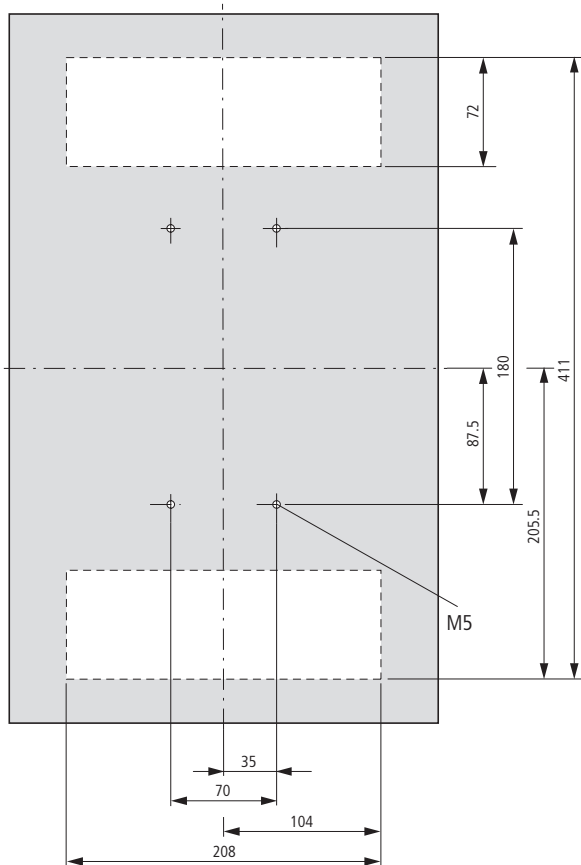

4-pol

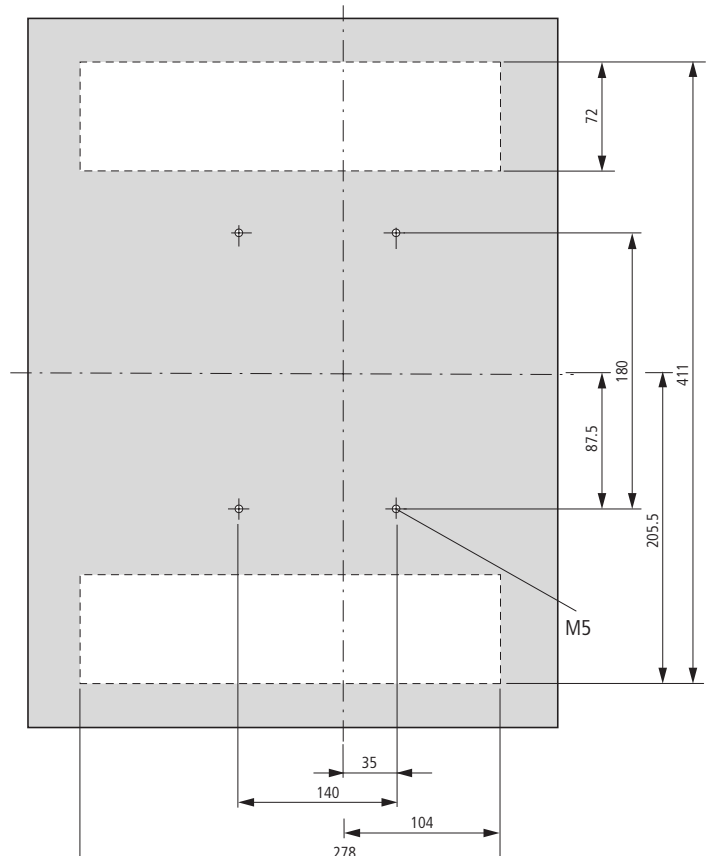

02/05 AWA1230-2277