

**PMC4-...**  
**PSC4-...**

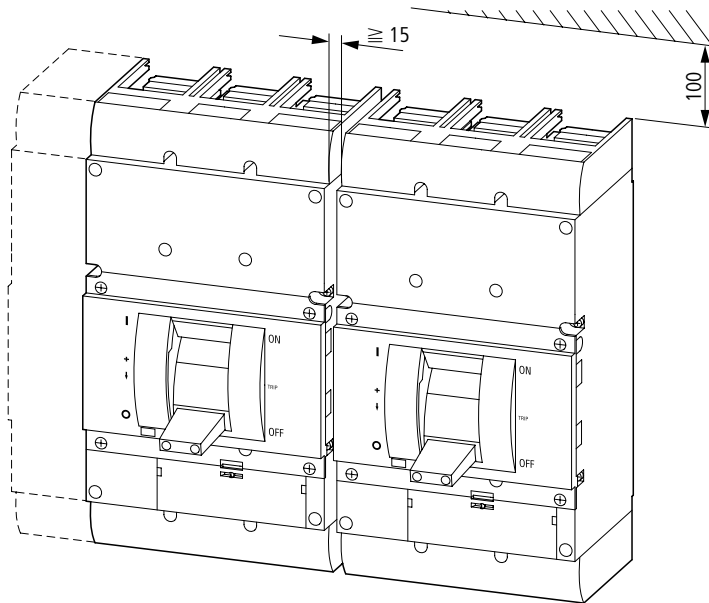
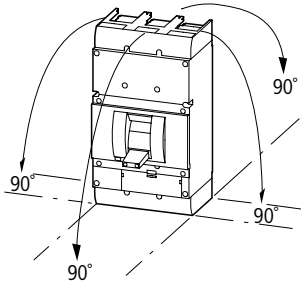

**Lebensgefahr durch elektrischen Strom!**  
 Nur Elektrofachkräfte und elektrotechnisch unterwiesene Personen dürfen die im Folgenden beschriebenen Arbeiten ausführen.

**Electric current! Danger to life!**  
 Only skilled or instructed persons may carry out the following operations.

**Tension électrique dangereuse !**  
 Seules les personnes qualifiées et averties doivent exécuter les travaux ci-après.

**Tensione elettrica: Pericolo di morte!**  
 Solo persone abilitate e qualificate possono eseguire le operazioni di seguito riportate.

**¡Corriente eléctrica! ¡Peligro de muerte!**  
 El trabajo a continuación descrito debe ser realizado por personas cualificadas y advertidas.

**Электрический ток! Опасно для жизни!**  
 Только специалисты или проинструктированные лица могут выполнять следующие операции.

**触电危险!**  
 只允许专业人员和受过专业训练的人员进行下列工作。

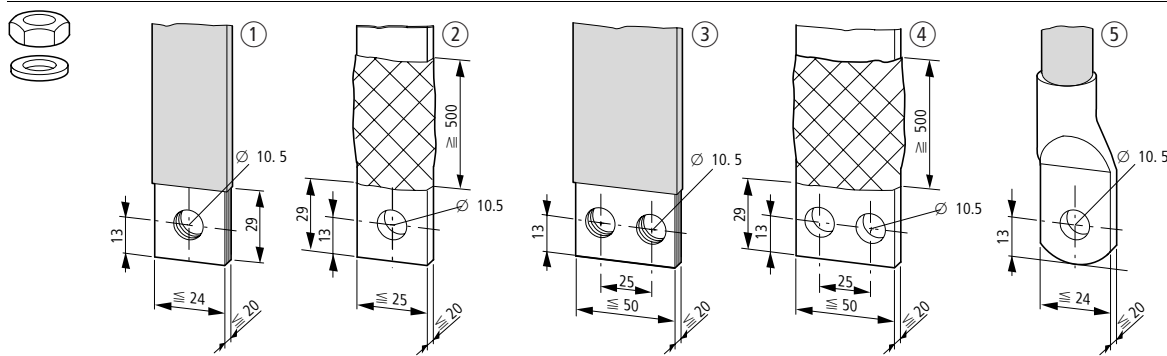

①	②	③	④	⑤
≅ (2 ×) 10 × 24 × 1 mm	≅ (2 ×) 25 × 10 mm	(2 ×) 10 × 50 × 1mm	(2 ×) 50 × 10 mm	4 × 50 – 185 mm <sup>2</sup>
→ XKB/PZ4-AF...	→ XKM1/PZ4-AP1...			→ NZM-XKV/PZ4-AV...
≅ (2 ×) 10 × 32 × 1 mm	≅ (2 ×) 50 × 10 mm			6 × 95 – 240 mm <sup>2</sup>
→ XKM1/PZ4-AP1...				4 × 300 mm <sup>2</sup>
≅ (2 ×) 10 × 50 × 1 mm				

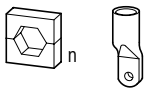

n = Anzahl der Pressungen  
 n = Number of crimps  
 n = Nombre de sertissages  
 n = Numero delle crimpature  
 n = Número de compresiones  
 n = Число прессований  
 n = 压制数量

n

2	KS120-NZM7
2	KS150-NZM7
2	NZM3-XKS185
4	NZM3-XKS240 → XKM1/PZ4-AP1...

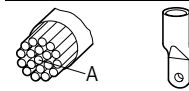

A

120 mm <sup>2</sup>	KS120-NZM7
150 mm <sup>2</sup>	KS150-NZM7
185 mm <sup>2</sup>	NZM3-XKS185
240 mm <sup>2</sup>	NZM3-XKS240 → XKM1/PZ4-AP1...

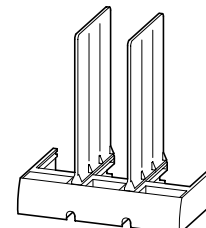
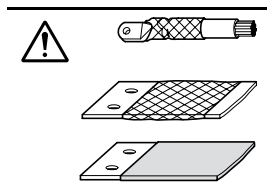
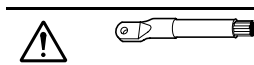
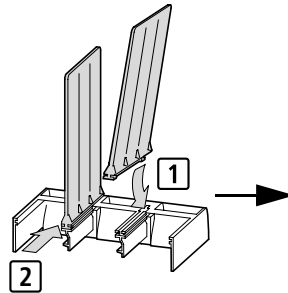
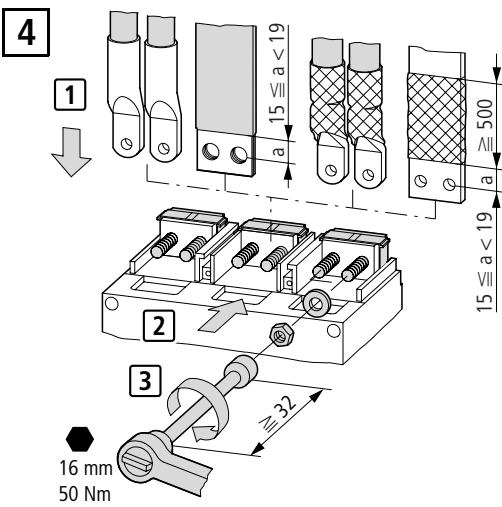
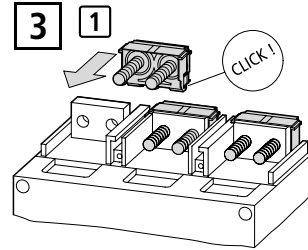
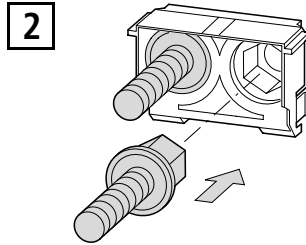
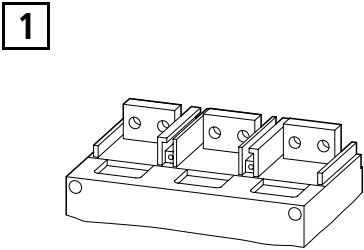

XKP/PZ4-PT...

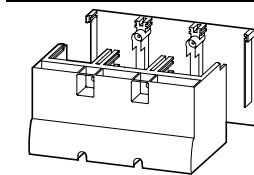
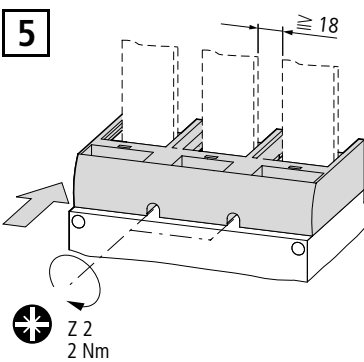
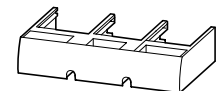

XKSA/PZ4-ASA...

**!**  $I_{cc} \geq 50 \text{ kA}$ .

Leiter mit einem nichtleitenden Material verbinden, das Kurzschlusskräfte von  $I_{cc} \geq 50 \text{ kA}$  aufnehmen kann.

Connect the cable with non-conductive material which can take short-circuit forces of  $I_{cc} \geq 50 \text{ kA}$ .

Raccorder les conducteurs avec un matériau non conducteur pouvant supporter des courts-circuits de  $I_{cc} \geq 50 \text{ kA}$ .

Ancorare i cavi con materiale non conduttivo che possa sopportare sollecitazioni di  $I_{cc} \geq 50 \text{ kA}$ .

Conectar el cable con material no conductor, el cual puede resistir fuerzas de cortocircuito de  $I_{cc} \geq 50 \text{ kA}$ .

Провод соединить с непроводящим материалом, могущим воспринимать усилия при коротком замыкании  $I_{cc} \geq 50 \text{ kA}$ .

将导线与能够承受  $I_{cc} \geq 50 \text{ kA}$  断路能力的非导电的材料连接。

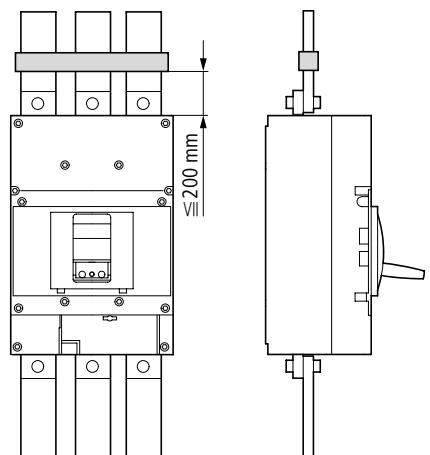

02/05 AWA1230-2220

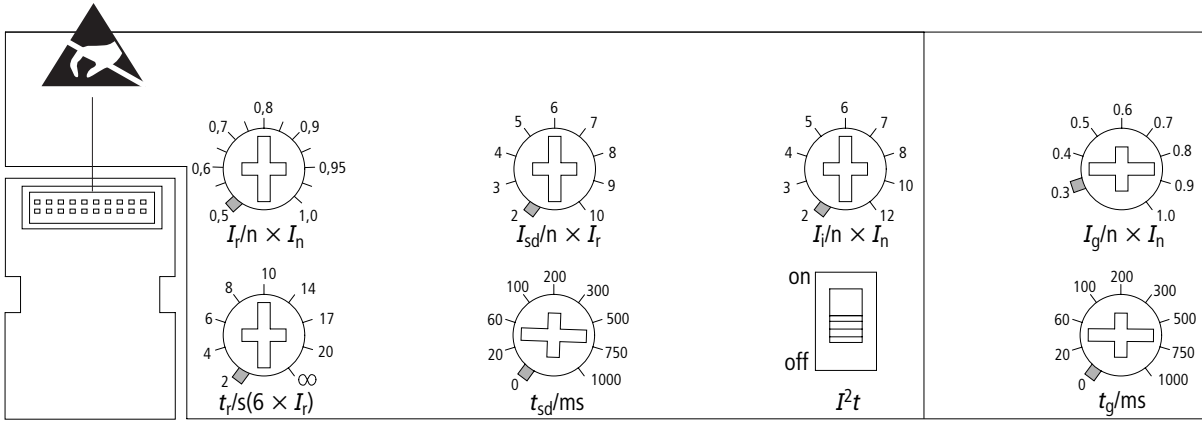

**1**

Einstellung  
Settings  
Réglages  
Regolazione  
Parámetros  
Настройка  
设置

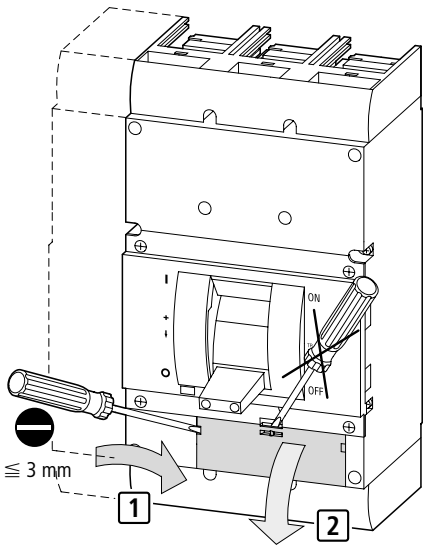

02/05 AWA 1230-2220

**2**

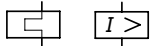

$I_r$  (A)  
 $I_i$  (A)  
 $I^2t$  ON/OFF  
 $I_g$  (A),  $t_g$  (ms)

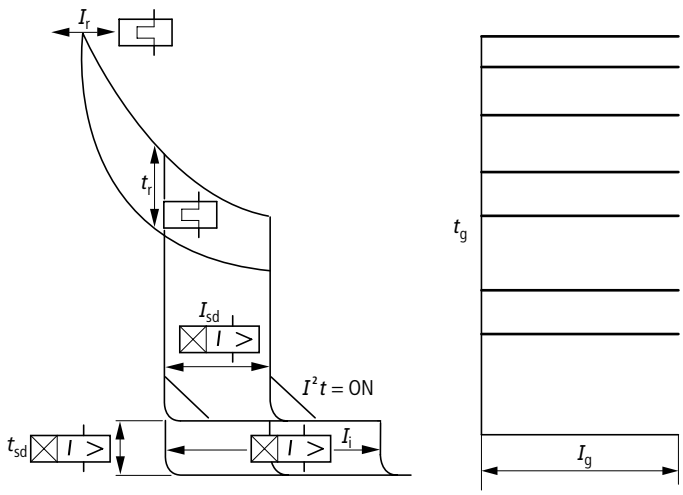
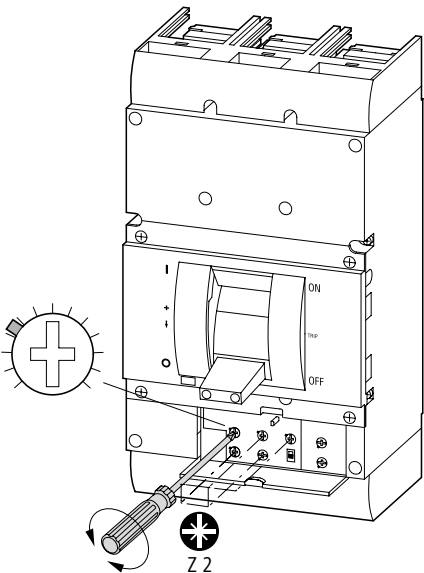



≧ XX. 13.05.02

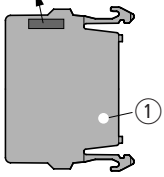

①  
Ab Produktionsdatum 20. KW 2002 einsetzbar (Verpackungsaufdruck 20W02)  
Can be used from production week 20/2002 (printed on package 20W02)  
Disponible à partir de date de production semaine 20 2002 (inscription sur emballage 20W02)  
Disponibile dalla settimana di produzione 20 / 2002 (stampato su imballaggio 20W02)  
Disponible a partir de la fecha de producción 20ª semana de 2002 (impreso sobre embalaje 20W02)  
Эксплуатируемый с даты производства 20-ая календарная неделя (шрифт на упаковке 20W02)  
自生产日期第 20 个日历周起可使用 (包装标号 20W02)

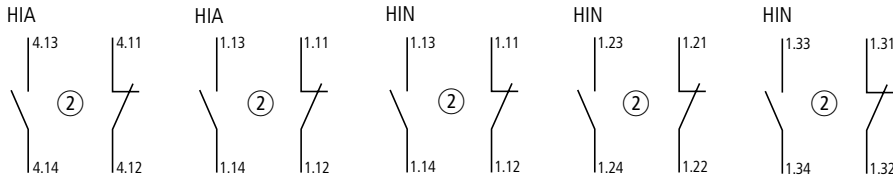

② oder – or – ou – oppure – ó – или – 或者

IEC



$$I_{th} = I_e$$

	$U_e$ (V)	$I_e$ (A)
AC-15	115	4
	230	4
	400	2
	500	1
DC-13	24	3
	42	1.7
	60	1.2
	110	0.8
	220	0.3

02/05 AWA1230-2220

1

Montage  
Mounting  
Montaggio  
Montaje  
Монтаж  
安装



OFF

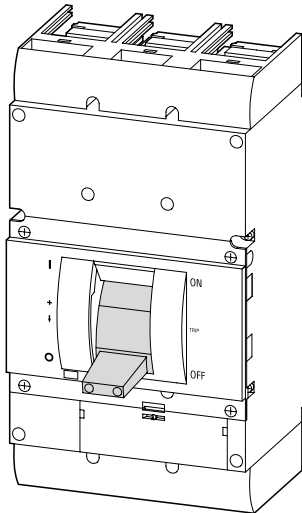

2

1



Z 2

1

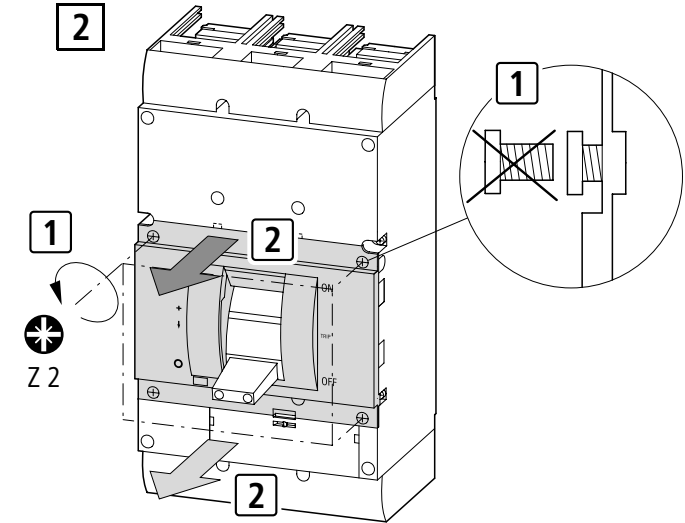

3

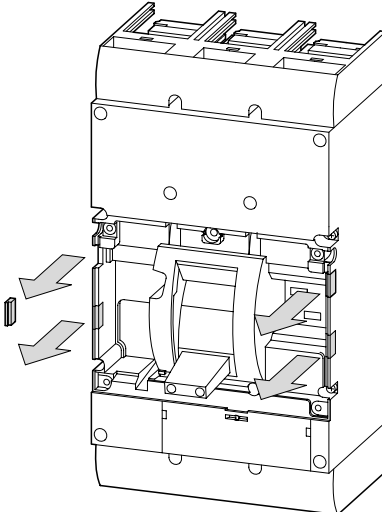

4

HIA  
HIA  
HIN  
HIN  
HIN  
HIN

CLICK!

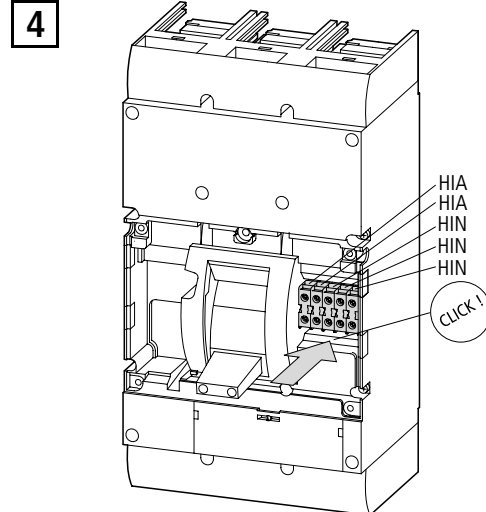

Einklappseite: 17 mm Beschnitt

5a

M22-K10, M22-K01

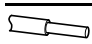
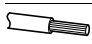
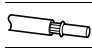
	2 × 0.75 – 2.5 mm <sup>2</sup>
	2 × 0.75 – 2.5 mm <sup>2</sup>
	2 × 0.75 – 2.5 mm <sup>2</sup>

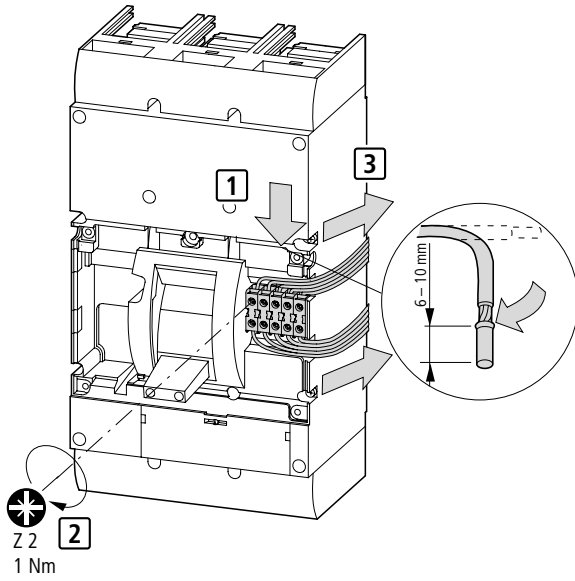

Einklappseite: 17 mm Beschnitt

6

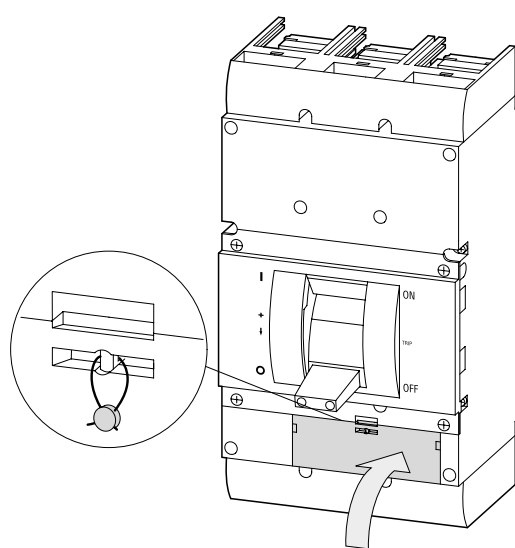
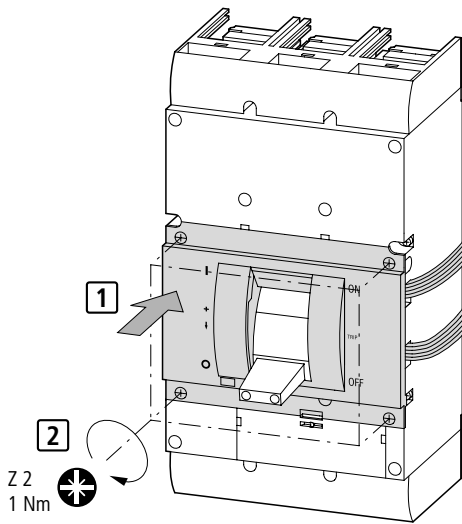

TEST 1

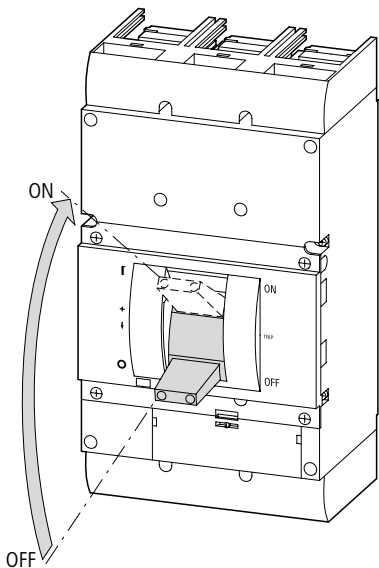

TEST 2

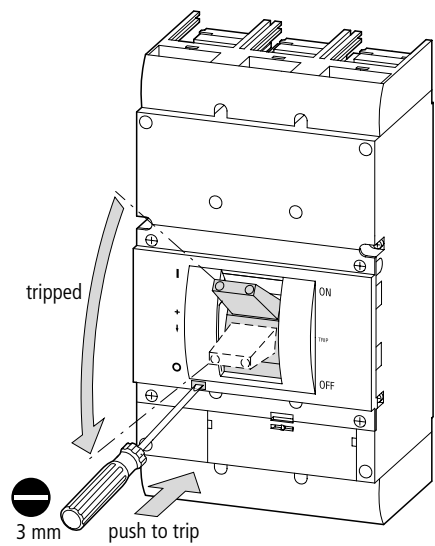

**TEST 3**

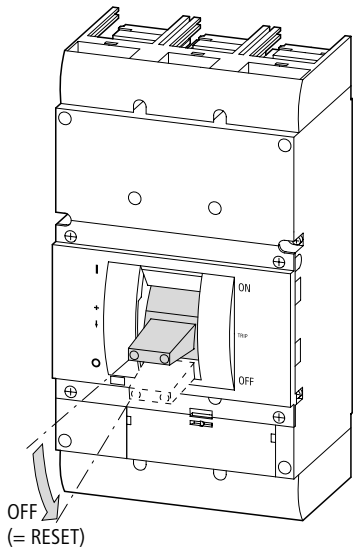

**1**

Demontage  
Dismantling  
Démontage  
Smontaggio  
Desmontaje  
Разборка  
拆卸

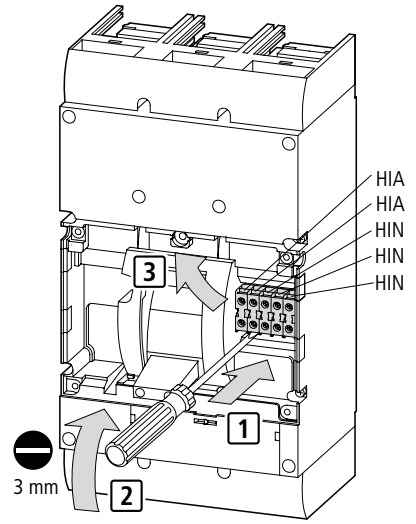

PMC4-.../...  
PSC4-.../...

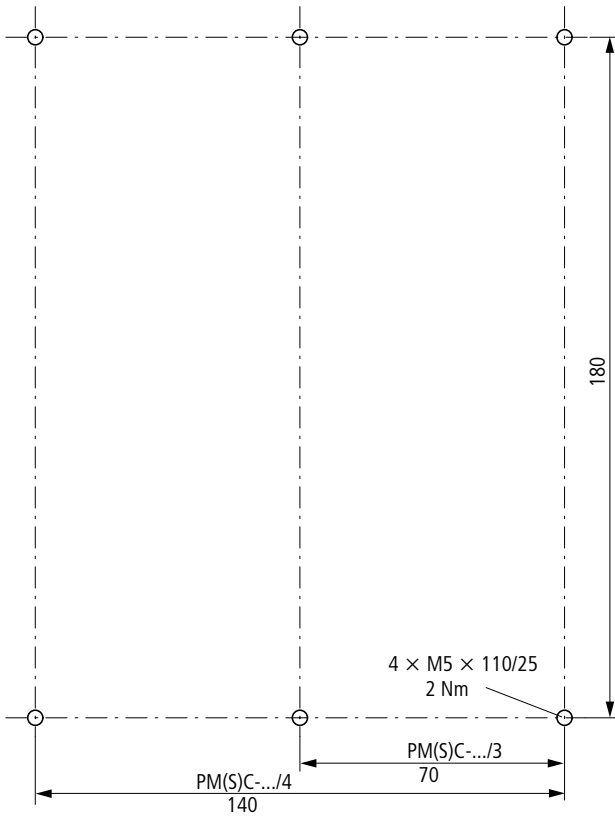

02/05 AWA1230-2220