

NZM2(-4)-XKA

NZM3(-4)-XKA1 NZM3(-4)-XKA2

...XKA... Mechanical (Tunnel) Lug Connector Kits for NZM2 and NZM3 Molded Case Circuit Breakers and Switches

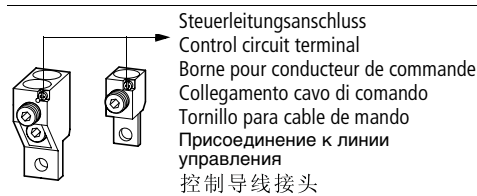

Cu

1 × 0.75 – 2.5 mm ²	1.2 Nm
2 × 0.75 – 1.5 mm ²	11 lb/in
1 × AWG 18 – 14	
2 × AWG 18 – 16	

Für Aluminium-(Al) und Kupferanschluss (Cu).
For aluminium (Al) and copper (Cu) connection.
Pour le raccordement aluminium (Al) et cuivre (Cu).
Per collegamento di alluminio (Al) e rame (Cu).
Para conexión de aluminio (Al) y de cobre (Cu).
Для алюминиевого (Al) и медного присоединения (Cu).

用于铝制 (AL) 和铜制 (Cu) 接头。

NZM2(-4)-XKA = 185 mm²/350 kcmil
NZM3(-4)-XKA1 = 185 mm²/350 kcmil
NZM3(-4)-XKA2 = 240 mm²/500 kcmil

Empfohlener max. Leiter
Recommended max. conductor
Section max. recommandée
Conduttore max. raccomandato
Conductor máx. recomendado
Рекомендуемый макс. проводник
推荐的最大导体

-NA, -CNA (UL/CSA models)

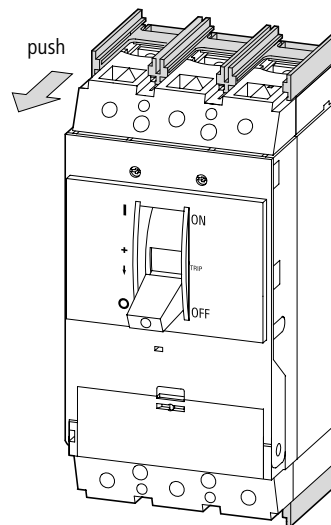

The barrier (shown shaded in the diagrams) is held tightly into grooves on top and bottom sides of the breaker or switch and must be removed in order to mount ...-XKA... Mechanical (Tunnel) lug connectors on NZM2 and NZM3 circuit breakers and switches.
To remove:
From the back of the device, use thumb pressure to push, or an appropriate tool to gently tap each side of the barrier to help slide it out.



Vorsicht!

Für die Durchführung der beschriebenen Arbeiten kann das Entfernen oder der Austausch von Teilen notwendig sein.
Bitte alle Installations-Anweisungen beachten, um die erforderlichen Luft- und Kriechstrecken nach dem Zusammenbau zu gewährleisten.

Caution!

The removal or exchange of parts during mounting may become necessary.
Refer to installation instructions for proper assembly and to maintain electrical clearances.

Attention !

L'enlèvement ou l'échange de certaines pièces pendant le montage est parfois nécessaire.
Consultez l'instruction d'assemblage pour assurer une installation conforme aux normes.

Attenzione!

Per l'esecuzione degli interventi descritti potrebbe essere necessaria la rimozione o sostituzione di alcuni pezzi.
Attendersi alle istruzioni d'installazione per garantire dopo l'assemblaggio le vie di dispersione necessarie.

Atención!

Con el fin de llevar a cabo los trabajos descritos, puede ser necesario eliminar o cambiar alguna pieza.
Le rogamos tenga en cuenta todas las instrucciones de instalación para así garantizar las líneas de fuga y eflujo necesarias tras el montaje.

Осторожно!

При проведении описанных процедур может возникнуть необходимость демонтировать или заменить детали.
Для обеспечения надлежащих зазоров и вывода тока утечки, соблюдайте все инструкции по монтажу.

小心!

执行所描述的操作时可能需要拆除或更换零部件。
请遵守所有相关的安装说明，
以确保在组装后能获得需要的空间距离或爬电距离。



Lebensgefahr durch elektrischen Strom!
Nur Elektrofachkräfte und elektrotechnisch unterwiesene Personen dürfen die im Folgenden beschriebenen Arbeiten ausführen.

Electric current! Danger to life!

Only skilled or instructed persons may carry out the following operations.

Tension électrique dangereuse !

Seules les personnes qualifiées et averties doivent exécuter les travaux ci-après.

Tensione elettrica: Pericolo di morte!

Solo persone abilitate e qualificate possono eseguire le operazioni di seguito riportate.

¡Corriente eléctrica! ¡Peligro de muerte!

El trabajo a continuación descrito debe ser realizado por personas cualificadas y advertidas.

Электрический ток! Опасно для жизни!

Только специалисты или проинструктированные лица могут выполнять следующие операции.

触电危险!

只允许专业人员和受过专业训练的人员进行下列工作。

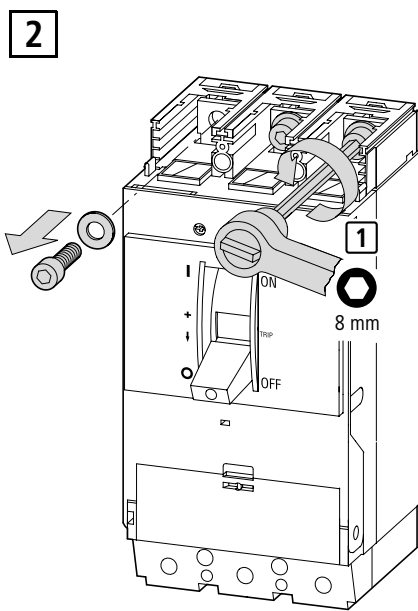
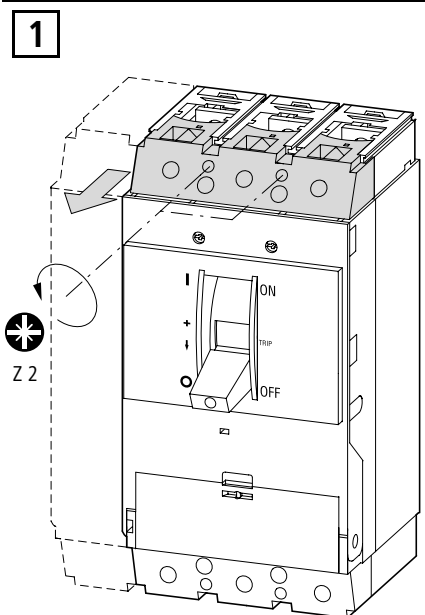

3a NZM2(-4)-XKA
NZM3(-4)-XKA1

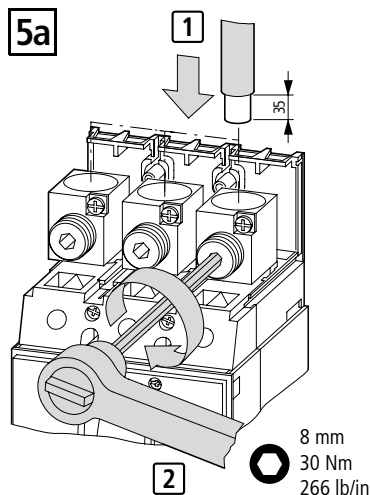
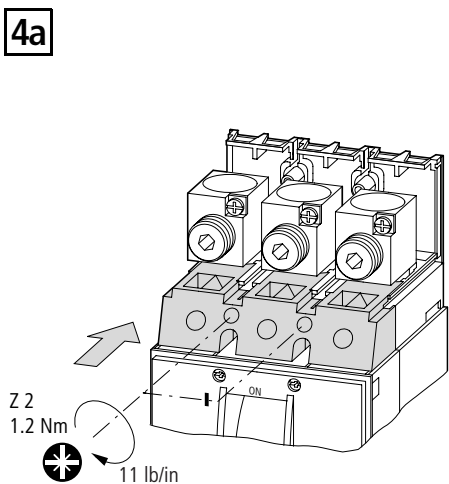
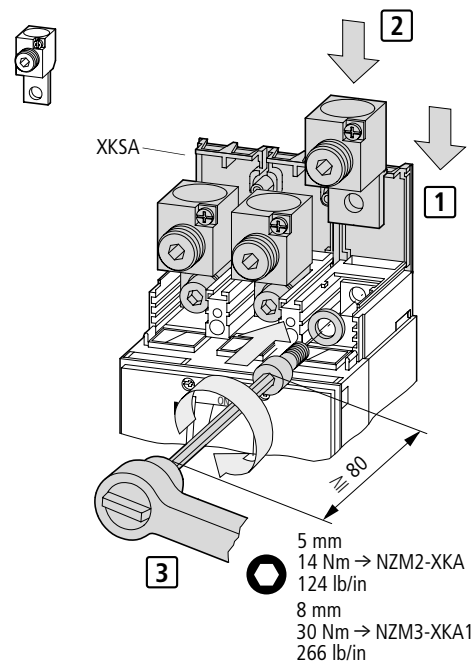

1 × 16 – 185 mm² *
1 × AWG 6 – 350 kcmil

*Je nach Kabelhersteller bis zu 185 mm² anschließbar.
Max. 185 mm² can be connected depending on the cable manufacturer.
Selon le fabricant de câble, possibilité de raccorder jusqu'à 185 mm².
Sezione max collegabile 185 mm² in base al produttore del cavo.
Dependiendo del fabricante del cable pueden conectarse hasta 185 mm².
В зависимости от производителя кабеля можно подключать до 185 мм².

根据不同的电缆制造商,可连接最大 185 mm²

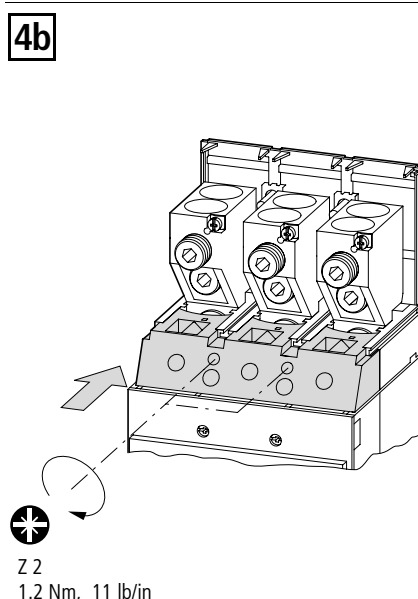
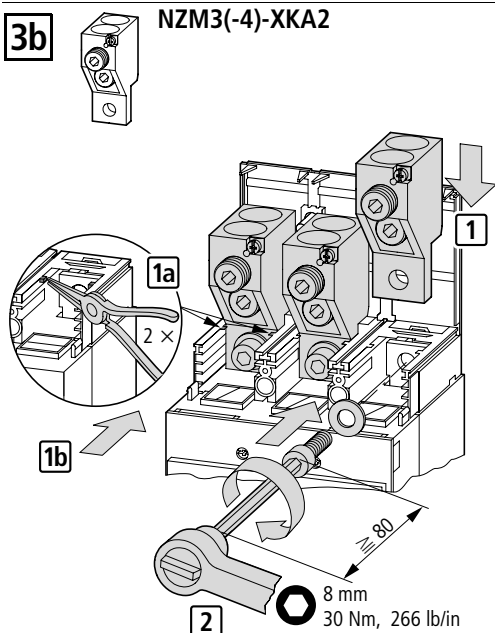

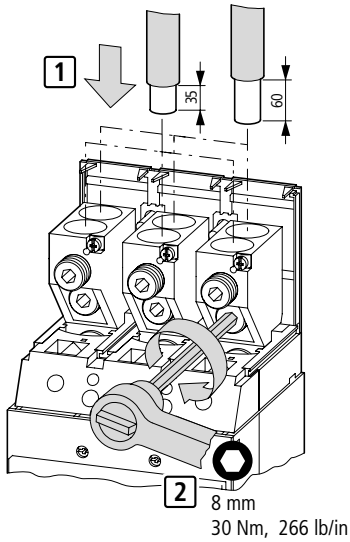
5b

1 × 50 – 240 mm ²
2 × 50 – 240 mm ²
1 × AWG 0 – 500 kcmil
2 × AWG 0 – 500 kcmil

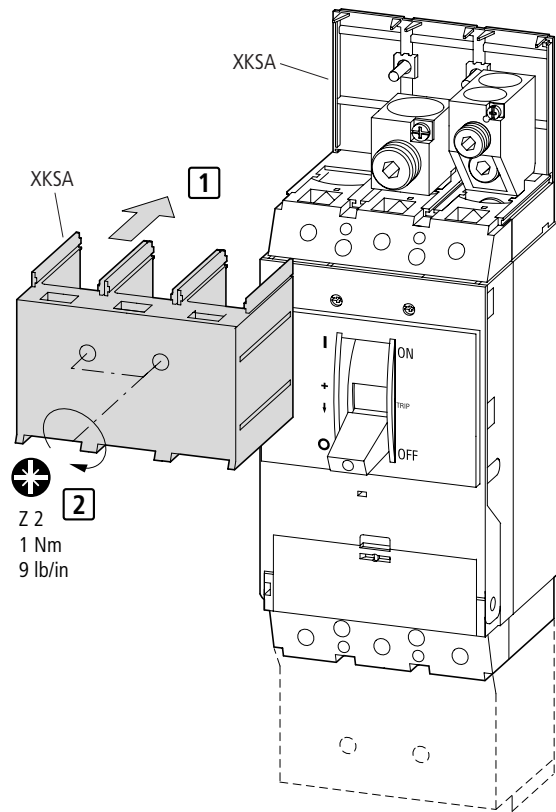
6

Use of Terminal Cover NZM3-XKSA on UL/CSA models:

- Mechanical (tunnel) lug connector kits ...XKA... come supplied with terminal cover NZM3-XKSA. Top and bottom portions of the terminal cover are mounted as shown in above diagrams and installation is always required.
- Terminal cover NZM3-XKSA maintains electrical clearances and provides protection against accidental contact with live parts in the incoming and outgoing supply circuit terminations of the circuit breaker or switch.

09/05 AWA 1230-2050