

**(+)NZM1-XDTV(R)**  
**(+)NZM2-XDTV(R)**

**1a** NZM.1...

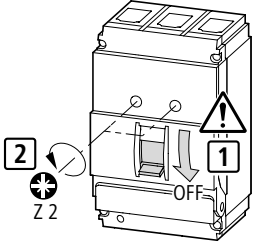

**2a** NZM.1...

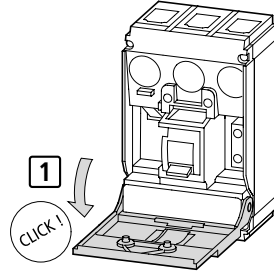

**1b** NZM.2...

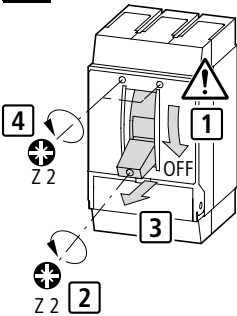

**2b** NZM.2...

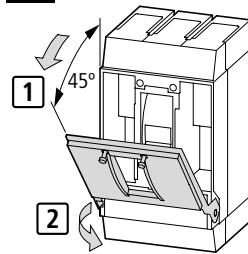

**3**

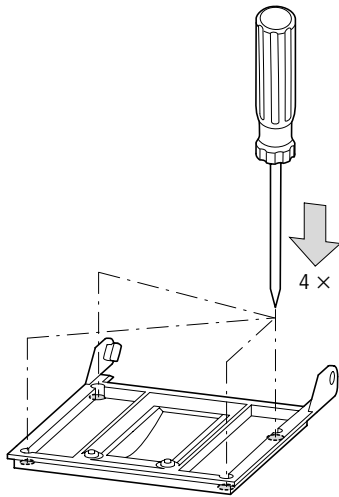

**4**

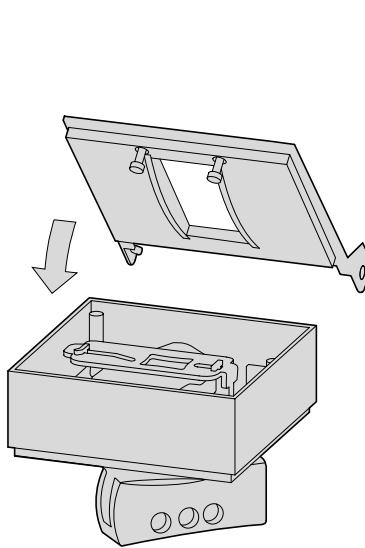

**5**

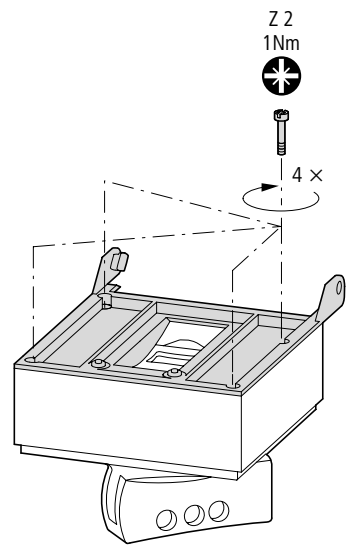

**6a**

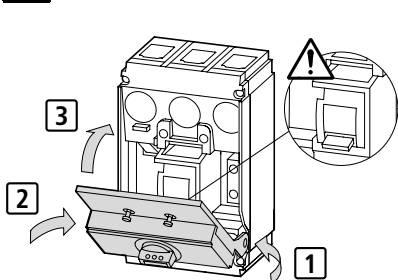

**6b**

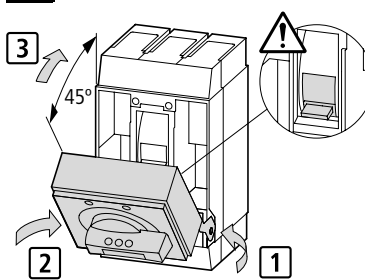

**7**

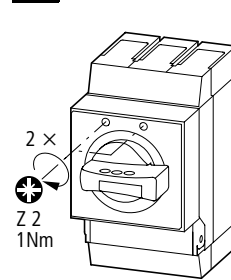

**Lebensgefahr durch elektrischen Strom!**  
 Nur Elektrofachkräfte und elektrotechnisch unterwiesene Personen dürfen die im Folgenden beschriebenen Arbeiten ausführen.

**Electric current! Danger to life!**  
 Only skilled or instructed persons may carry out the following operations.

**Tension électrique dangereuse !**  
 Seules les personnes qualifiées et averties doivent exécuter les travaux ci-après.

**Tensione elettrica! Pericolo di morte!**  
 Solo persone abilitate e qualificate possono eseguire le operazioni di seguito riportate.

**¡Corriente eléctrica! ¡Peligro de muerte!**  
 El trabajo a continuación descrito debe ser realizado por personas cualificadas y advertidas.

**Электрический ток! Опасно для жизни!**  
 Только специалисты или проинструктированные лица могут выполнять следующие операции.

**触电危险!**  
 只允许专业人员和受过专业训练的人员进行下列工作。

|                      | a   | b   | c    | d | e  |
|----------------------|-----|-----|------|---|----|
| NZM.1-..., (P)N1-... | 53  | 133 | 14.4 | 9 | 11 |
| NZM.2-...            | 103 | 143 | 10.4 | 9 | 9  |

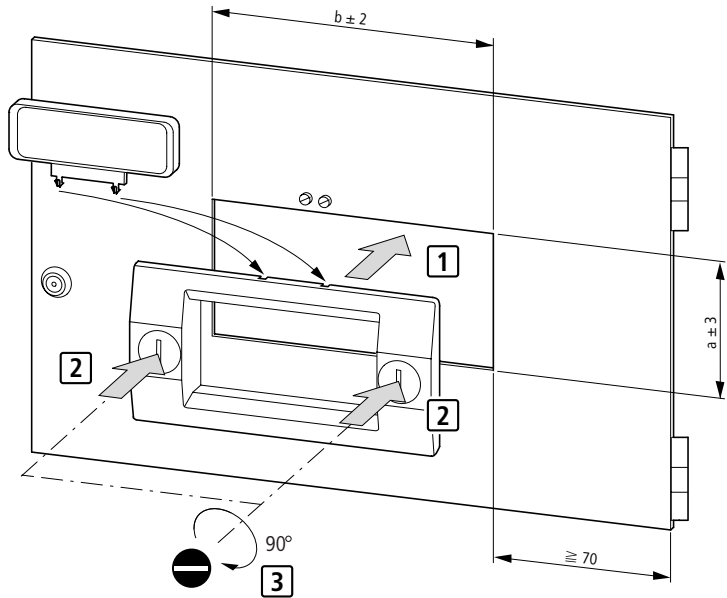
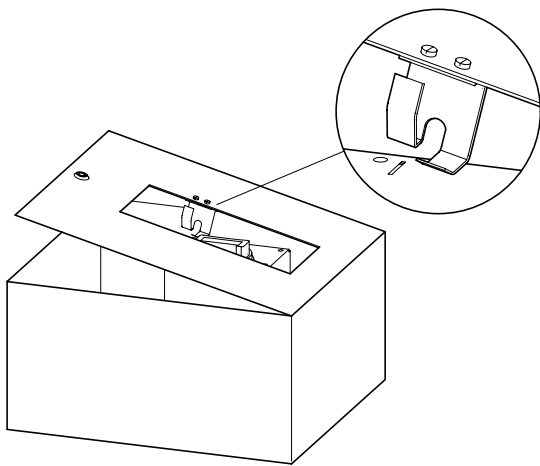
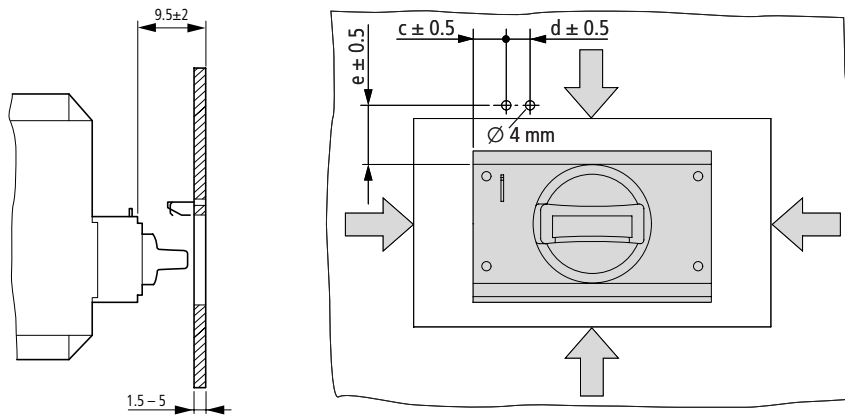

01/03 AWA1230-1993

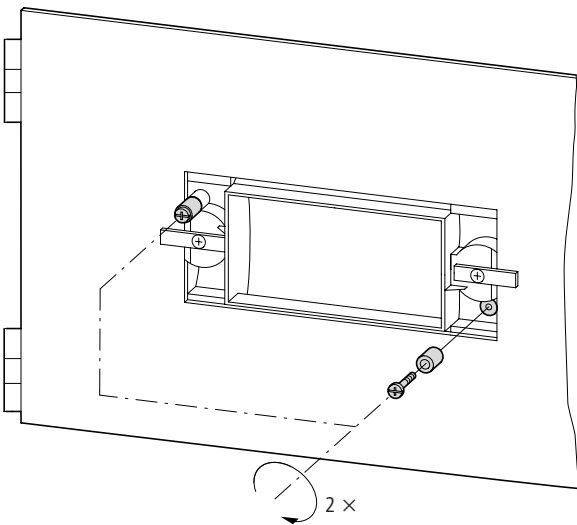

**TEST 1**

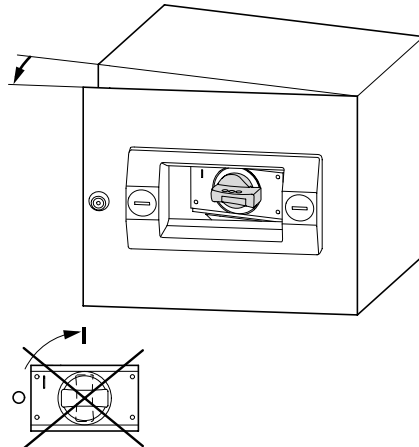

**TEST 2**

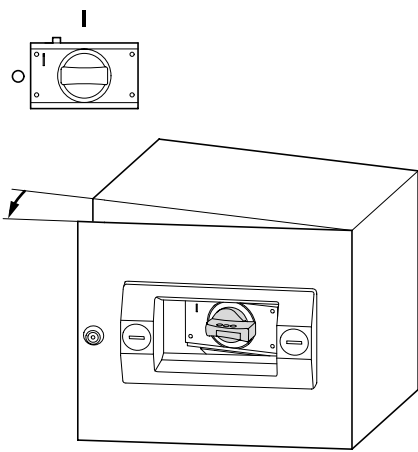

**TEST 3**

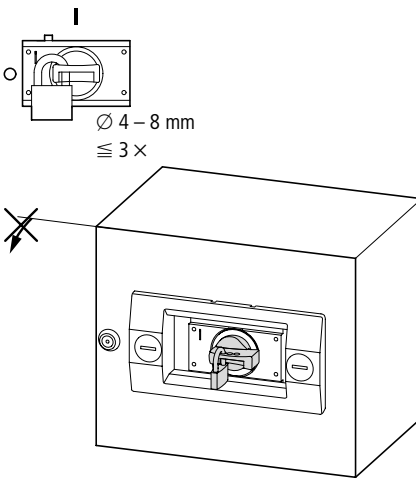

**TEST 4**

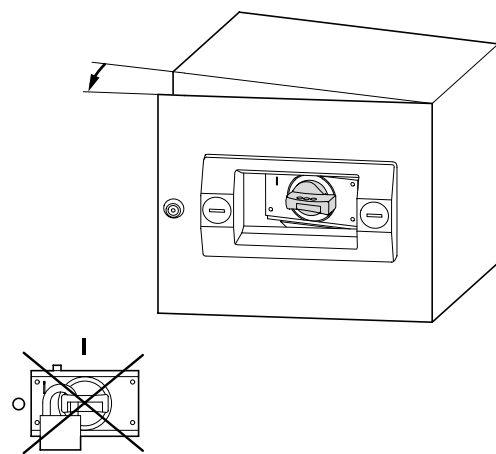
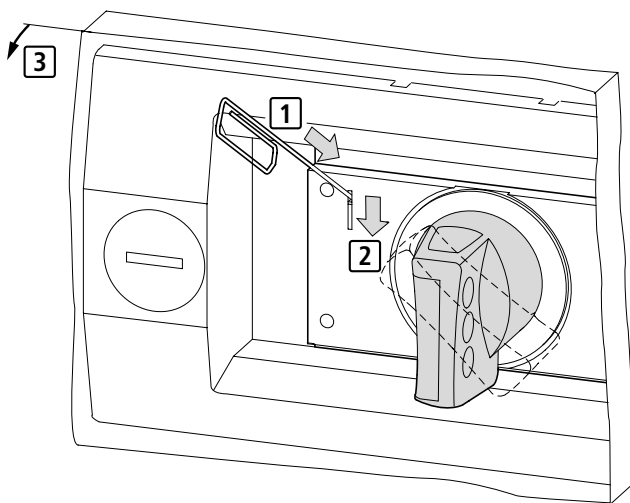
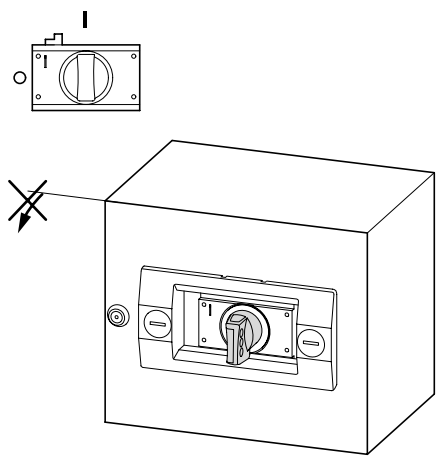

01/03 AWA1230-1993

**⚠ Warning!**  
Es ist nicht zulässig, die Abschließposition in ON-Stellung für den NOT-AUS zu aktivieren!

**¡Advertencia!**  
No está permitido activar la posición enclavable en la posición ON en el pulsador de paro de emergencia!

**Warning!**  
It is not permitted to activate the locking position in ON position for the emergency-stop!

**Предупреждение!**  
Активировать запирающую позицию в положении ON для аварийного отключения не разрешается!

**Avertissement !**  
Il est interdit d'activer la position de verrouillage en ON pour l'arrêt d'urgence !

**警告!**  
不允许紧急停止情况下在 ON 位置上激活锁止位置

**Avvertimento!**  
Non è permesso lucchettare nella posizione ON la maniglia a comando rinviato per arresto di emergenza!

