

Circuit-breaker
Switch-disconnector

3 pole
NZMN3
NZMH3
PN3
N3
NS3

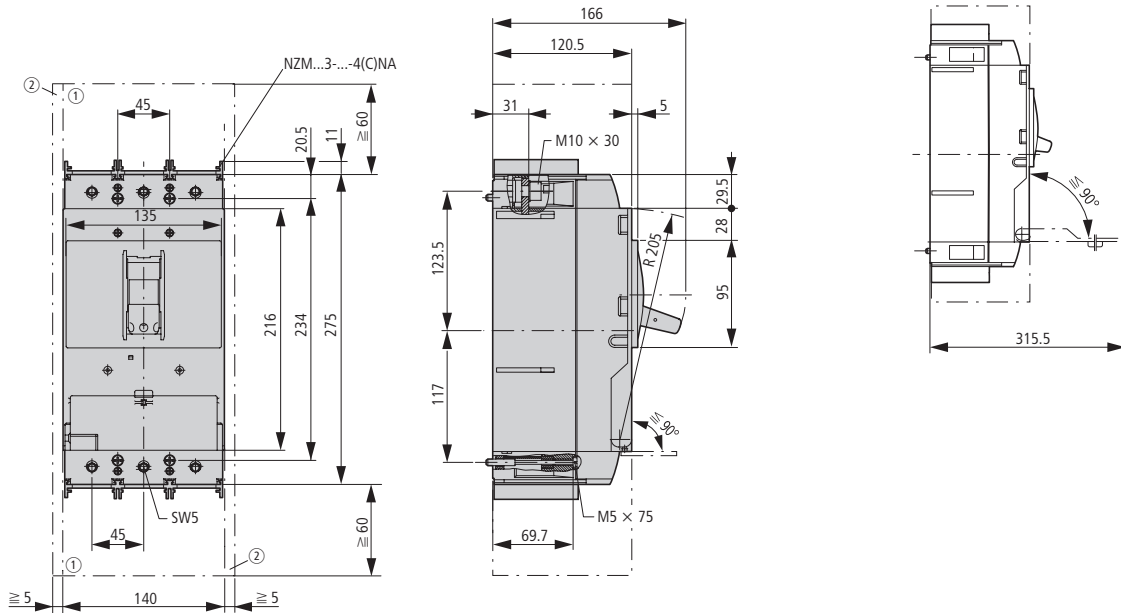

- ① Blow-out space, minimum distance to other parts \cong 60 mm
- ② Minimum distance to adjacent parts \cong 5 mm

Circuit-breaker
Switch-disconnector

4 pole
NZMN3-4
NZMH3-4
PN3-4
N3-4

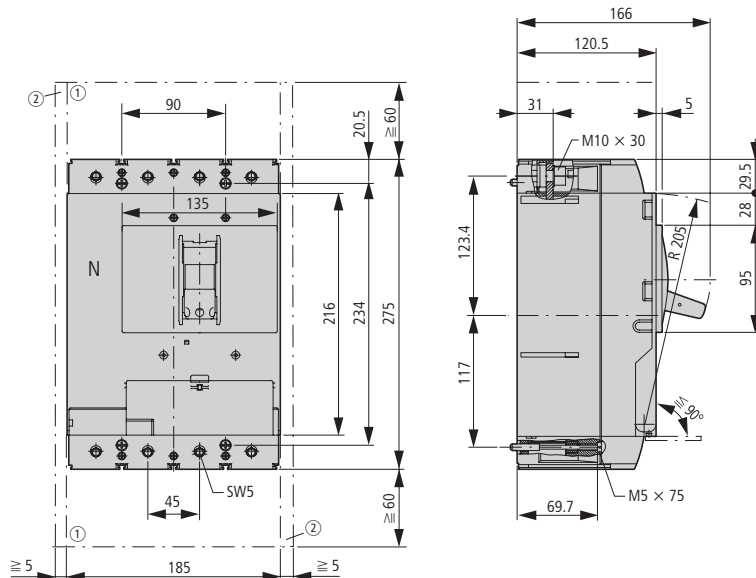

- ① Blow-out space, minimum distance to other parts \cong 60 mm
- ② Minimum distance to adjacent parts \cong 5 mm

